

INSTRUCTION MANUAL

ITEM NO.: BT-B3187551

BT-B3187561

BT-B3187562

18V CORDLESS BRUSHLESS RIVETER





WARNING To reduce the risk of injury, user must read and understand operator's manual.



AVERTISSEMENT Afin de réduire le risque de blessures, l'utilisateur doit lire et bien comprendre le manuel.

ADVERTENCIA Para reducir el riesgo de lesiones, el usuario debe leer y entender el manual.



- *Do not dispose of electrical appliances as unsorted municipal waste, use separate collection facilities.*
- *Contact your local government for information regarding the collection systems available. If electrical appliances are disposed of in landfills or dumps, hazardous substances can leak into the groundwater and get into the food chain, damaging your health and well-being.*
- *When replacing old appliances with new ones, the retailer is legally obligated to take back your old appliance for disposal at least for free of charge.*

Contents

1	Product Specification Information	3
2	Rivet Tool Outline Structure	5
3	Warnings and Cautions	6
4	Symbols of the Product Safety	8
5	Warranty	8
6	Product Key Feature	9
7	Operate application	10
(1)	Operation	10
(2)	Battery with a Tool system	11
(3)	Charger with Battery	12
(4)	Maintenance	13
(5)	Inner Dia. Measurement	14
(6)	Installing and Change of the Nosepiece	15

1. Product Specification Information

(1) Technical Data

		BT-B3187551	BT-B3187561	BT-B3187562
Voltage		DC 18V	DC 18V	DC 18V
Pulling Force		2,500LBS (11,120N)	5,000LBS (22,241N)	5,000LBS (22,241N)
Device Stroke		25mm (0.984")	25mm (0.984")	25mm (0.984")
Setting Speed		Max. 25mm / sec.		
Standard Nosepiece and Capacity	3/32" (2.4mm)	V		
	1/8" (3.0mm/3.2mm)	V	V	V
	5/32" (4.0mm)	V	V	V
	3/16" (4.8mm ~5.0mm)	V	V	V
	7/32" (5.6mm)		V	V
	1/4" (6.4mm)		V	V
Power Lighting (3 Green LED)		V	V	V
Trigger of Switch		V	V	V
Tool Dimensions		H 306.2mm(12"), L 307.3mm(12-1/8"), D 70.5mm(2-6/8")		
Net Weight (W/O Battery)		3.7Lb(1.68kg)	3.73Lb(1.69kg)	3.73Lb(1.69kg)
Operating Temp. of the Environmental		25°C		
Operating Environmental		In door		
Battery		BP1826S41 (2.6Ah Li-ion BATTERY) BP1852S41 (5.2Ah Li-ion BATTERY)		
Charger (110VAC~ 240VAC)		BC18S41		

(2) Power Lighting define

The Tool body can directly display the battery power capacity information. The tool body battery capacity is displayed as the relative SOA (Safe Operation Area). Each LED segment represents 33 percent of the full battery charge capacity. The LED pattern definition is given in the table below.

Power Capacity	LED Segments		
Percentage (%)	LED1	LED2	LED3
0% ~ 34%			
34% ~ 67%			
67% ~ 100%			

(3) Tool Status Lighting Define

The tool has designed 2 white LEDs for operation, an easy to checking work area is ready and safe. The light-emitting diodes (LED) precisely aligned to the workpiece are integrated into the body and can support the area light of the rivet operation.

The LED light will follow the trigger switch condition, once the trigger switch is on it will start to work, the tool lighting can auto turn on and auto turn off when the trigger and when the release switch will be on and off

2. Rivet Tool Outline Structure

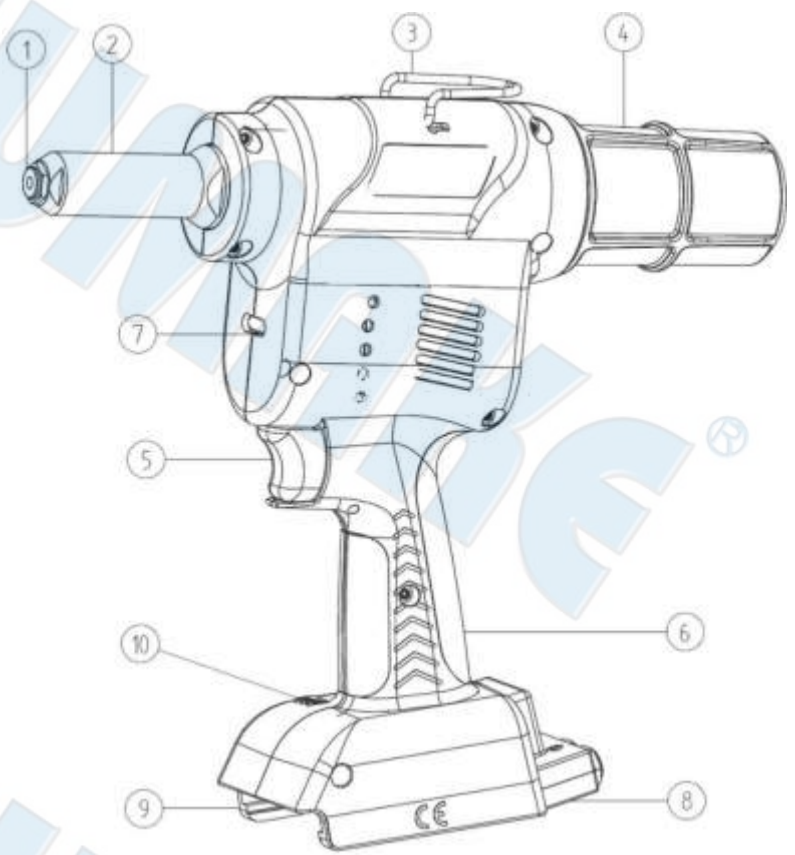
Product outline	Product Define: Battery rivet tool, cordless	
	Product Name: Cordless Rivet tool.	
	Tool serial model no.: BT-B3187551, BT-B3187561, BT-B3187562	
Function Description		
	1. Nose piece	6. Handle
	2. Nose housing	7. Led
	3. Tool hanger	8. Nose piece storage
	4. Mandrel collector	9. Batter slide
	5. Trigger switch	10. Battery power light

(1) Before to use tool please double confirm mandrel collector is locked

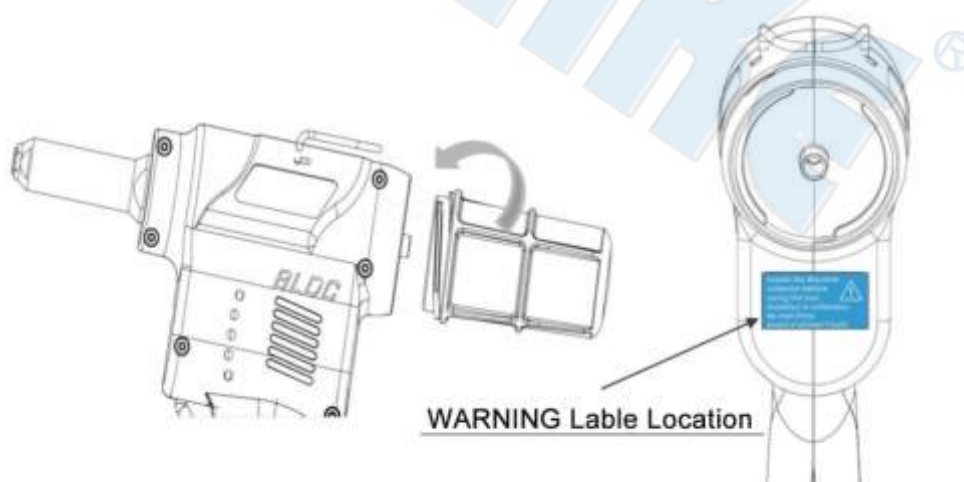

3. Warnings and Cautions

WARNING

Read all safety warnings and all instructions and specifications provided with this power tool. Failure to follow the warnings and instructions may result in electric shock, fire and/or serious injury.

Save all warnings and instructions for future reference.

The term "power tool" in the warnings refers to your mains-operated (corded) power tool or battery-operated (cordless) power tool.

General Power Tool Safety Warnings – Work area safety

- (1) **Keep work area clean and well lit.** Cluttered or dark areas invite accidents.
- (2) **Do not operate power tools in explosive atmospheres, such as in the presence of flammable liquids, gases or dust.** Power tools create sparks which may ignite the dust or fumes.
- (3) **Keep children and bystanders away while operating a power tool.** Distractions can cause you to lose control.

General Power Tool Safety Warnings –Electrical safety

- (1) **Power tool plugs must match the outlet. Never modify the plug in any way. Do not use any adapter plugs with earthed(grounded) power tools.** Unmodified plugs and matching outlets will reduce risk of electric shock.
- (2) **Avoid body contact with earthed or grounded surfaces, such as pipes, radiators, ranges and refrigerators.** There is an increased risk of electric shock if your body is earthed or grounded.
- (3) **Do not expose power tools to rain or wet conditions.** Water entering a power tool will increase the risk of electric shock.
- (4) **Do not abuse the cord. Never use the cord for carrying, pulling or unplugging the power tool. Keep cord away from heat, oil, sharp edges or moving parts.** Damaged or entangled cords increase the risk of electric shock.
- (5) **When operating a power tool outdoors, use an extension cord suitable for outdoor use.** Use of a cord suitable for outdoor use reduces the risk of electric shock.
- (6) **If operating a power tool in a damp location is unavoidable, use a residual current device (RCD) protected supply.** Use of an RCD reduces the risk of electric shock.
- (7) If the replacement of the supply cord is necessary, this has to be done by the manufacturer or his agent in order to avoid a safety hazard.

General Power Tool Safety Warnings –Personal safety

- (1) **Stay alert, watch what you are doing and use common sense when operating a power tool. Do not use a power tool while you are tired or under the influence of drugs, alcohol or medication.** A moment of inattention while operating power tools may result in serious personal injury.
- (2) **Use personal protective equipment. Always wear eye protection.** Protective equipment such as dust mask, non-skid safety shoes, hard hat, or hearing protection used for appropriate conditions will reduce personal injuries.
- (3) **Prevent unintentional starting. Ensure the switch is in the off-position before connecting to power source and/or battery pack, picking up or carrying the tool.** Carrying power tools with your finger on the switch or energising power tools that have the switch on invites accidents.
- (4) **Remove any adjusting key or wrench before turning the power tool on.** A wrench or a key left attached to a rotating part of the power tool may result in personal injury.
- (5) **Do not overreach. Keep proper footing and balance at all times.** This enables better control of the power tool in unexpected situations.
- (6) **Dress properly. Do not wear loose clothing or jewellery. Keep your hair, clothing and gloves away from moving parts.** Loose clothes, jewellery or long hair can be caught in moving parts.

- (7) **If devices are provided for the connection of dust extraction and collection facilities, ensure these are connected and properly used.** Use of dust collection can reduce dust-related hazards.
- (8) **Do not let familiarity gained from frequent use of tools allow you to become complacent and ignore tool safety principles.** A careless action can cause severe injury within a fraction of a second.

**General Power Tool Safety Warnings –Power tool use and care**

- (1) **Do not force the power tool. Use the correct power tool for your application.** The correct power tool will do the job better and safer at the rate for which it was designed.
- (2) **Do not use the power tool if the switch does not turn it on and off.** Any power tool that cannot be controlled with the switch is dangerous and must be repaired.
- (3) **Disconnect the plug from the power source and/or the battery pack from the power tool before making any adjustments, changing accessories, or storing power tools.** Such preventive safety measures reduce the risk of starting the power tool accidentally.
- (4) **Store idle power tools out of the reach of children and do not allow person unfamiliar with the power tool or these instructions to operate the power tool.** Power tools are dangerous in the hands of untrained users.
- (5) **Maintain power tools. Check for misalignment or binding of moving parts, breakage of parts and any other condition that may affect the power tool's operation. If damaged, have the power tool repaired before use.** Many accidents are caused by poorly maintained power tools.
- (6) **Keep cutting tools sharp and clean.** Properly maintained cutting tools with sharp cutting edges are less likely to bind and are easier to control.
- (7) **Use the power tool, accessories and tool bits etc. in accordance with these instructions, taking into account the working conditions and the work to be performed.** Use of the power tool for operations different from those intended could result in a hazardous situation.
- (8) **Keep handles and grasping surfaces dry, clean and free from oil and grease.** Slippery handles and grasping surfaces do not allow for safe handling and control of the tool in unexpected situations.











**General Power Tool Safety Warnings – Battery tool use and care**

- (1) **Recharge only with the charger specified by the manufacturer.** A charger that is suitable for one type of battery pack may create a risk of fire when used with another battery pack.
- (2) **Use power tools only with specifically designated battery packs.** Use of any other battery packs may create a risk of injury and fire.
- (3) **When battery pack is not in use, keep it away from other metal objects, like paper clips, coins, keys, nails, screws or other small metal objects, that can make a connection from one terminal to another.** Shorting the battery terminals together may cause burns or a fire.
- (4) **Under abusive conditions, liquid may be ejected from the battery; avoid contact. If contact accidentally occurs, flush with water. If liquid contacts eyes, additionally seek medical help.** Liquid ejected from the battery may cause irritation or burns.
- (5) **Do not use a battery pack or tool that is damaged or modified.** Damaged or modified batteries may exhibit unpredictable behaviour resulting in fire, explosion or risk of injury.
- (6) **Do not expose a battery pack or tool to fire or excessive temperature.** Exposure to fire or temperature above 130 °C may cause explosion.
- (7) **Follow all charging instructions and do not charge the battery pack or tool outside the temperature range specified in the instructions.** Charging improperly or at temperatures outside the specified range may damage the battery and increase the risk of fire.

**General Power Tool Safety Warnings –Service**

- (1) **Have your power tool serviced by a qualified repair person using only identical replacement parts.** This will ensure that the safety of the power tool is maintained.
- (2) **Never service damaged battery packs.** Service of battery packs should only be performed by the manufacturer or authorized service providers.

4. Symbols of the Product Safety

	1. Read instruction manual before operating and observe all warning.
	2. Wear eye protection
	3. Wear ear Protection
	4. Direct Current (DC)
	5. Observe caution and safety notes.
	6. Recyclable.
	7. WEEE (Waste of electrical and electronic equipment)
	8. Do not expose to wet or rain conditions.
	9. Do not operate in an explosive atmosphere
	10. Do not disassemble

5. Warranty

The manufacturer will be responsible for replacing the tool against defects or poor workmanship for 12 months from the date of shipping. Any other problem caused by malfunction of the equipment or misuse of the tool is not covered under this warranty.

6. Product Key Feature

(1) Auto reverse function

Immediately after rivet mandrel break-off, the tool system will detect and start auto-reverse mode stop the pulling process then moves the jaw assembly back to the initial position. It can save time and power energy while making sure the tool is immediately ready for use.

(2) BLDC technology

A BLDC motor is a brushless DC motor that, instead of brushes that are susceptible to wear, uses electrical sensors to detect the rotor 's position and commutate the stator coil via circuit breakers. Special software in the electronics controls the motor. The advantages of a BLDC motor include high efficiency, long service life, particularly smooth running with a precision ball bearing and a reduction in electrical noise radiation

(3) Lighting

The light-emitting diodes (LED) precisely aligned to the workpiece are integrated into the rivet tool body, can support the tool operation, and system process controlled: The LED remains illuminated after the trigger of the main switch, which allows a continuous workflow even under the bad area lighting conditions. Lighting off: Saves electricity, each trigger the switch and release lighting can auto on/off.

(4) Sliding design of the battery

A new sliding battery (Patent) can support close to the tool body and the battery power light indicator charging status display prevents unpleasant surprises. when the battery removes the tool or does not use status it will be into power-saving and off. By turning on the device the battery is automatically woken and is immediately ready for use. The battery pack range is 2.6A/h battery full charge lasts for up to 1000+(AL/4.8mm) riveting operations. We provide more battery capacity types to choose from.

(5) Charging unit

Charging unit with quick-charge function. The battery can be used on the tool again after only 45 minutes of charging. When the battery keeps charging condition until 60 minutes it will fully be charging. (for 2600mA/h battery pack) The SUMAKE® Li-ion chargers are available for 110 VAC to 240 VAC voltages. The charger comes with a Euro plug as standard. Other versions for the EU, UK, and USA are available on request.

7. Operate application

(1) Operation

Note: Be sure to install the mandrel container to the tool before operating the tool. Of the mandrel container is not installed to the tool, the operate will have risk and dangerous.

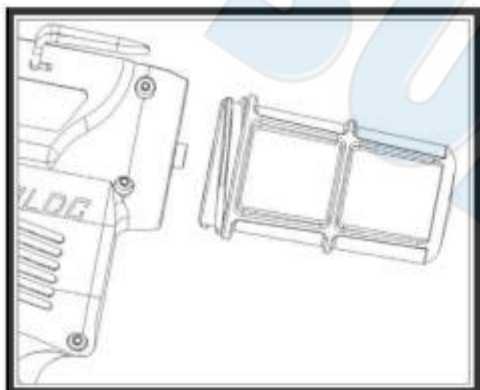

Be check the rivet in the right direction then can into the Nosepiece.

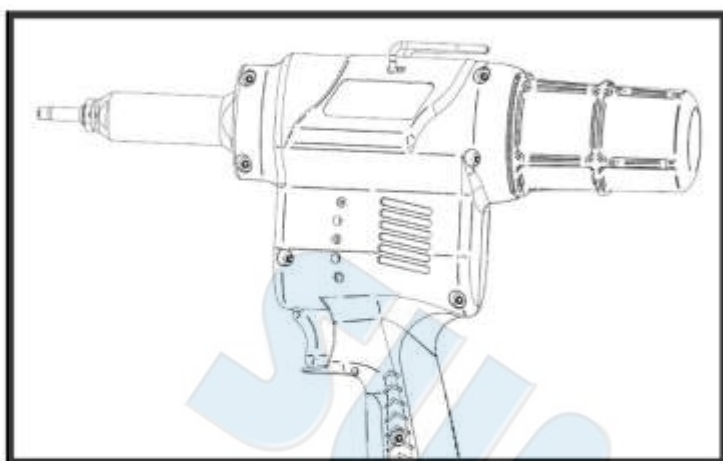
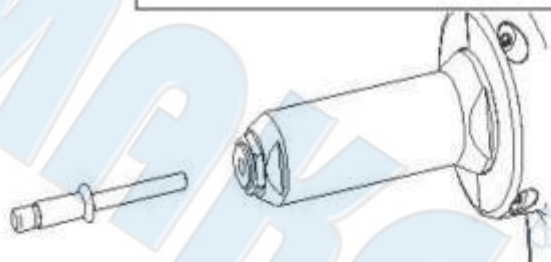

It is ready for work, just trigger the switch.

The rivet has two choose can operate, please see as follows:

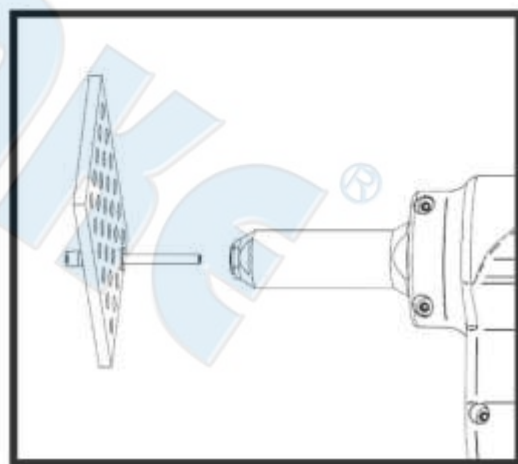
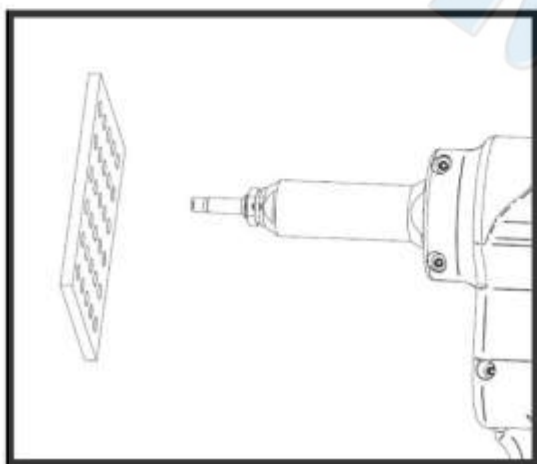

(2) Battery with a Tool system

 **WARNING** Recharge only with the charger specified for the battery. For specific charging instructions, read the operator's manual supplied with your charger and battery.

-Removing/Inserting the Battery- To remove the battery, push in the release buttons and pull the battery pack away from the tool.

 **WARNING** Always lock the trigger or remove the battery pack any time the tool is not in use.

To insert the battery, slide the pack into the body of the tool. Make sure it latches securely into place.



Read instruction manual before use

Step 1: From Bottom to up



Step 2: From Front to back



Step 3: Ready for use



(3) Charger with Battery

The BC18S41, charger only accepts BP1826S41, BP1852S41 18 V Li-Ion battery packs. This charger requires no adjustment and is designed to be as easy as possible to operate.

- A. Plug the charger into an appropriate outlet before inserting the battery pack. (Refer to the Charger Specifications)
- B. Insert the battery pack into the charger, making sure the pack is fully seated in the charger. The red (charging) light will blink continuously indicating that the charging process has started.
- C. The completion of the charge will be indicated by the Greenlight remaining ON continuously. The pack is fully charged and may be used at this time or left in the charger.

Note 1: To ensure maximum performance and life of Li-Ion battery packs, charge the battery for a minimum of 8 hours before first use.

Note 2: Recommend when the battery is fully charging please remove it from the charger, and let can into the battery power-saving mode.



Read instruction manual before use

Step 1. Battery ready to plug



Step 2. Battery plug in



Step 3. Battery Ready to charging



(4) Maintenance

A. Maintaining Tool

Clean and lubricate the nose of the tool after heavy use (3000+ rivets) or if the tool becomes contaminated with dust and debris.



Read instruction manual before use

Step 1. Remove the battery pack.

Step 2. Remove the nose housing from the tool and the nose piece from the housing.

Step 3. Remove the guide (with jaws), pusher tube, and spring from the tool.

Step 4. Clean all pieces with a dry cloth and inspect for damage. If damaged, return to a SUMAKE service facility for repairs.

Step 5. Apply a small amount of xxx-xxx-xxx oil to the nosepieces and nose housing inside then reassemble, as shown. Ensure the jaws are properly seated in the guide.

B. Troubleshooting

Reset function: If the tool does not move to its initial position after releasing the switch or stops during the setting stroke; If the end of the broken-off mandrel sticks out from the nose piece, switch off the tool and remove the mandrel. Otherwise, the broken-off mandrels may become clogged and cause a malfunction of the tool.

Please remove the battery pack from the tool and re-plugging the battery then check this issue is fixed, if it still keeps this problem please separate the tool and battery, then for repairs, return the tool, battery pack, and charger to the nearest authorized service center or contact with manufactory.

(5) Inner & Outer Dia. Measurement

A. How are the Nosepiece and rivet measured? As follows the verification process.

- Before the operation, measure the outer dimension of your rivets.
- Use the chart to ensure the correct pairing for rivet size and nosepiece
- Select the corresponding nosepiece

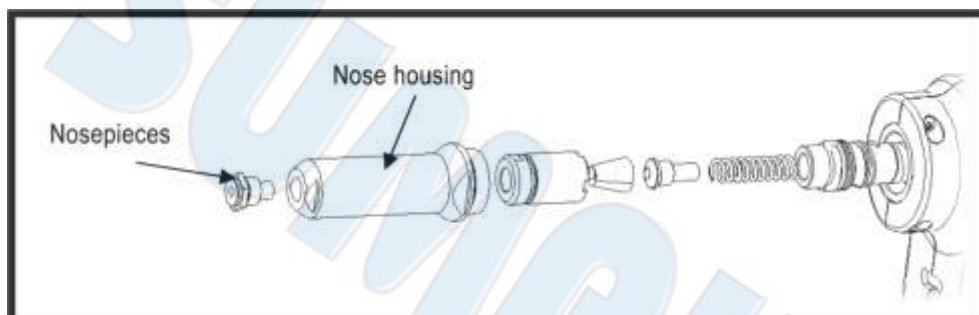

B. Rivet Inner and Outer information:

Note: The table is a general specification, if need detail please check with the tool manufactory.

Inner Dia. Of Nosepiece	Outer Dia. Of Rivets Available	Nosepiece display
0.173"(4.4mm)	1/4"(6.4mm)	6.4mm
0.157"(4mm)	7/32"(5.6mm)	5.6mm
0.134"(3.4mm)	3/16"(4.8mm)	4.8mm
0.114"(2.9mm)	5/32"(4mm)	4.0mm
0.094"(2.4mm)	1/8"(3.2mm)	3.2mm
0.075"(1.9mm)	3/32"(2.4mm)	2.4mm

(6) Installing and Change of the Nosepiece

Note: The whole kit box has provided two hand wrenches, it's for changing the Nosepiece. This page is a simple Nosepiece change process, please read as follows:

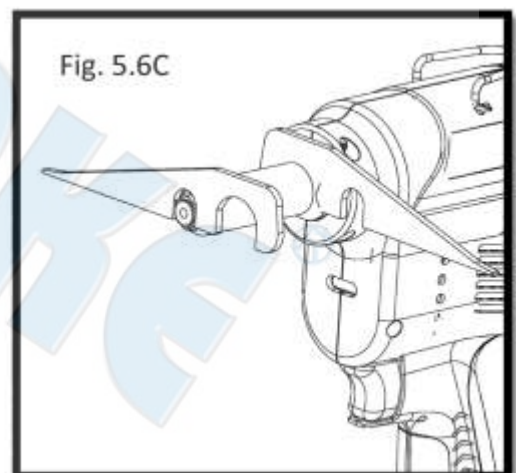
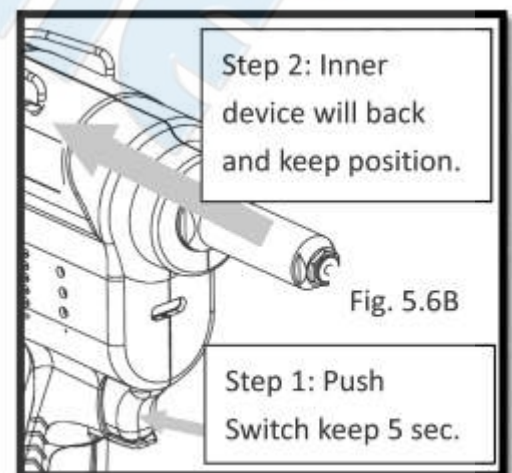
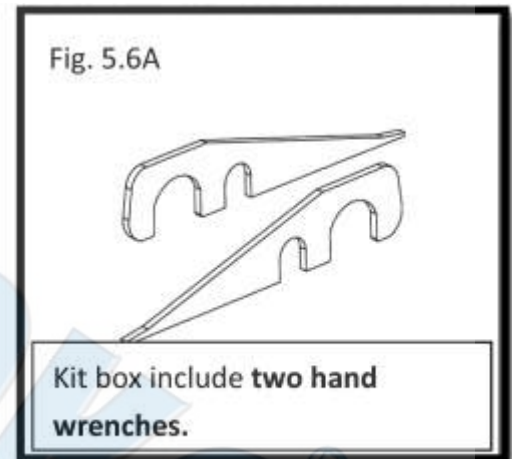
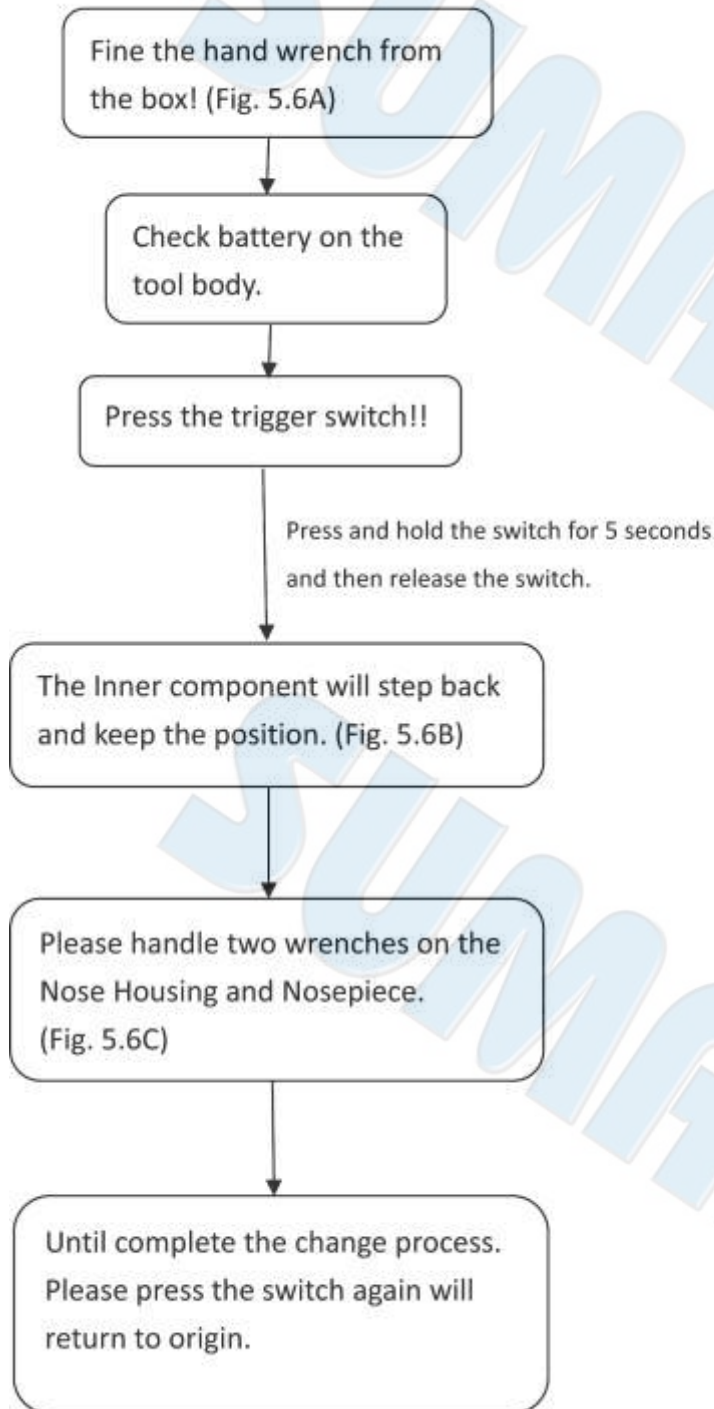

Our company reserves the right to modify the product without prior notice.

18V 3/16"(4.8MM) BRUSHLESS CORDLESS RIVETER

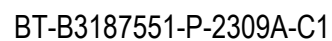

BT-B3187551

18V 3/16"(4.8MM) BRUSHLESS CORDLESS RIVETER

PARTS LIST

No.	Parts No.	Description	Q'ty	No.	Parts No.	Description	Q'ty
1-1	B3187551-01-1	Nosepiece (3/16")(Φ4.8)	1	41	B3187551-41	Gear	1
1-2	B3187551-01-2	Nosepiece (5/32")(Φ4.0)	1	42	B3187551-42	Switch	1
1-3	B3187551-01-3	Nosepiece (1/8")(Φ3.0/3.2)	1	43	B3187551-43	Right Housing	1
1-4	B3187551-01-4	Nosepiece (3/32")(Φ2.4)	1	44	B3187551-44	Light Pipe	3
2	B3187551-02	Head	1	45	B3187551-45	Control Case	1
3	B3187551-03	Jaws	3	45-1	B3187551-45-1	Control	1
4	B3187551-04	O-Ring	2	45-2	B3187551-45-2	Control Panel Protective Case	1
5	B3187551-05	Jaw Pusher For (3/16") Φ4.8, (5/32") Φ4.0, (1/8") Φ3.2, (3/32") Φ2.4	1	46	B3187551-46	Power Outlet	1
6	B3187551-06	Jaw Housing	1	47	B3187551-47	Left Housing	1
7	B3187551-07	Spring	1	50	B3187551-50	Screw	9
12	B3187551-12	Mandrel Collector	1	52	B3187551-52	25/10 Wrench	2
12-1	B3187551-12-1	Warning Sticker	1	53	B3187551-53	M3 Screw	2
13	BP1826S41	18V 2.6Ah Li-ion Battery (Opt.)	1	54	B3187551-54	M3 Nut	2
	BP1852S41	18V 5.2Ah Li-ion Battery (Opt.)	1	55	B3187551-55	M2 Screw	1
14	BC18S41	Battery Changer (Opt.)	1	61	B3187551-61	Cover	1
15A	B3187551-15A	Ball Screw Drive Assy	1	62	B3187551-62	Led Sticker	1
21	B3187551-21	Lampshade	1	64	B3187551-64	Right Sticker	1
23	B3187551-23	M8 Nosepiece Storage Up	1	65	B3187551-65	Left Sticker	1
24	B3187551-24	M8 Nosepiece Storage Down	1	66	B3187551-66	O-Ring	4
26	B3187551-26	Suspension Bracket	1	Option (Can Not Put Nosepiece)			
29	B3187551-29	Tube, Short	1	56	B3187551-56	Protective Box	1
38	B3187551-38	Led	1	For Rivet Bite Function (Option)			
39	B3187551-39	Motor	1	58-1	B3187551-58-1	Nosepiece (3/16")(Φ4.8)	1
				58-2	B3187551-58-2	Nosepiece (5/32")(Φ4.0)	1
				58-3	B3187551-58-3	Nosepiece (1/8")(Φ3.0/3.2)	1
				58-4	B3187551-58-4	Nosepiece (3/32")(Φ2.4)	1
				63	B3187551-63	25/14 Wrench	2

BT-B3187561

18V 1/4"(6.4MM) BRUSHLESS CORDLESS RIVETER

BT-B3187562

18V 3/32"~1/4"(2.4~6.4MM) BRUSHLESS CORDLESS RIVETER

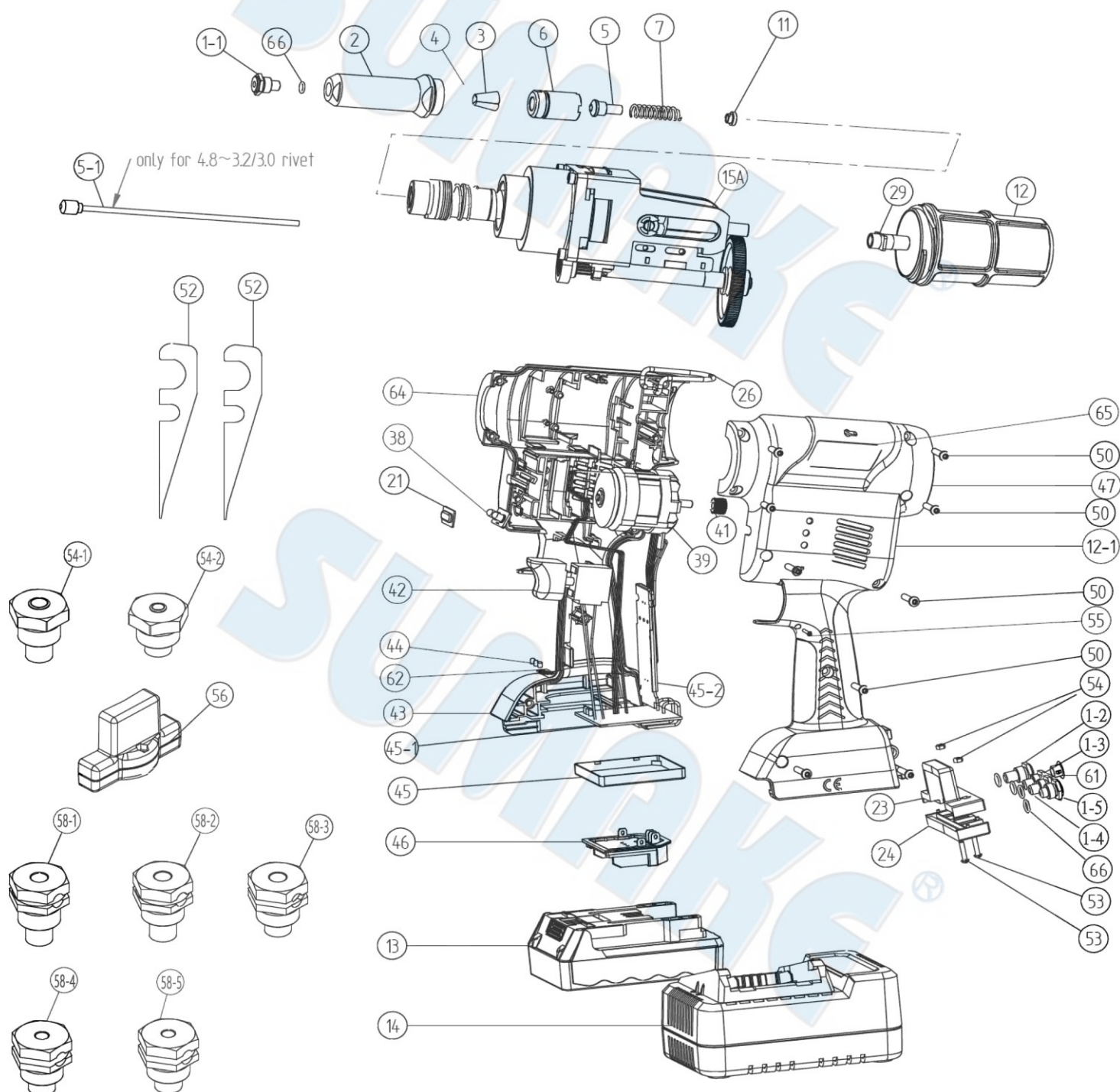

BT-B3187561

18V 1/4"(6.4MM) BRUSHLESS CORDLESS RIVETER

BT-B3187562

18V 3/32"~1/4"(2.4~6.4MM) BRUSHLESS CORDLESS RIVETER

PARTS LIST

No.	Parts No.	Description	Q'ty
2	B3187561-02	Head	1
3	B3187561-03	Jaws	3
4	B3187551-04	O-Ring	2
5	B3187561-05	Jaw Pusher For (1/4") Φ 6.4, (7/32") Φ 5.6	1
5-1	B3187561-05-1	Jaw Pusher For (3/16") Φ 4.8~ Φ 3.2/3.0	1
6	B3187561-06	Jaw Housing	1
7	B3187551-07	Spring	1
11	B3187561-11	Spring Positioning Gasket	1
12	B3187551-12	Mandrel Collector	1
12-1	B3187551-12-1	Warning Sticker	1
13	BP1826S41	18V 2.6Ah Li-ion Battery (Opt.)	1
	BP1852S41	18V 5.2Ah Li-ion Battery (Opt.)	1
14	BC18S41	Battery Changer (Opt.)	1
15A	B3187551-15A	Ball Screw Drive Assy	1
21	B3187551-21	Lampshade	1
23	B3187561-23	7/16" Nosepiece Storage Up	1
24	B3187561-24	7/16" Nosepiece Storage Down	1
26	B3187551-26	Suspension Bracket	1
29	B3187551-29	Tube, Short	1
38	B3187551-38	Led	1
39	B3187551-39	Motor	1
41	B3187561-41	Gear	1
42	B3187551-42	Switch	1
43	B3187551-43	Right Housing	1
44	B3187551-44	Light Pipe	3
45	B3187551-45	Control Case	1
45-1	B3187561-45-1	Control	1

No.	Parts No.	Description	Q'ty
45-2	B3187551-45-2	Control Panel Protective Case	1
46	B3187551-46	Power Outlet	1
47	B3187551-47	Left Housing	1
50	B3187551-50	Screw	9
52	B3187561-52	25/14 Wrench	2
53	B3187551-53	M3 Screw	2
54	B3187551-54	M3 Nut	2
55	B3187551-55	M2 Screw	1
61	B3187561-61	Cover	1
62	B3187551-62	Led Sticker	1
64	B3187551-64	Right Sticker	1
65	B3187551-65	Left Sticker	1
66	B3187561-66	O-Ring	5
For BT-B3187561 Nosepiece			
1-1	B3187561-01-1	Nosepiece (1/4")(Φ 6.4)	1
1-2	B3187561-01-2	Nosepiece (7/32")(Φ 5.6)	1
1-3	B3187561-01-3	Nosepiece (3/16")(Φ 4.8)	1
1-4	B3187561-01-4	Nosepiece (5/32")(Φ 4.0)	1
1-5	B3187561-01-5	Nosepiece (1/8")(Φ 3.2/3.0)	1
Option (Can Not Put Nosepiece)			
56	B3187561-56	Protective Box	1
For Monbolt Rivet Only (Option)			
57-1	B31875561-57-1	Nosepiece (1/4")(Φ 6.4)	1
57-2	B3187561-57-2	Nosepiece (3/16")(Φ 4.8)	1
For BT-B3187562 Nosepiece Rivet Bite Function			
58-1	B3187562-58-1	Nosepiece (1/4")(Φ 6.4)	1
58-2	B3187562-58-2	Nosepiece (7/32")(Φ 5.6)	1
58-3	B3187562-58-3	Nosepiece (3/16")(Φ 4.8)	1
58-4	B3187562-58-4	Nosepiece (5/32")(Φ 4.0)	1
58-5	B3187562-58-5	Nosepiece (1/8")(Φ 3.2/3.0)	1

EU Declaration of Conformity (DOC)

We: **SUMAKE INDUSTRIAL CO., LTD.**

4F, No. 351, Yangguang St., Neihs District, Taipei City, Taiwan

declare in sole responsibility that the equipment

Equipment : **CORDLESS RIVETER TOOL**

Model/ Serial No. : **BT-B3187551, BT-B3187561, BT-B3187562**

The object of the declaration described above is in conformity with the relevant union harmonization legislation:

- Machinery Directive 2006/42/EC
- Electromagnetic Compatibility 2014/30/EU
- RoHS 2015/863

The following harmonised standards and technical specifications have been applied:

- EN 62841-1:2015
- EN ISO 12100:2010
- EN ISO 11148-1:2011
- EN ISO 11148-1:2011
- EN IEC 55014-1:2021
- EN IEC 55014-2:2021

Data:

Noise level:

Sound pressure level: Load: 78 dB(A)

Sound power level: Load: 89 dB(A)

Vibration level:

No Load: < 2.5 m/s²

Name and Signature/Position



Mike Su – Managing Director

Date and Place

2025/5/2

Taipei, Taiwan

BT-B31875-D-2509B-C1F

EU Declaration of Conformity (DOC)

We: **SUMAKE INDUSTRIAL CO., LTD.**

4F, No. 351, Yangguang St., Neihu District, Taipei City, Taiwan

declare in sole responsibility that the equipment

Equipment : **BATTERY CHARGER**

Model/ Serial No. : **BC18S41A, BC18S41B, BC18S41C**

The object of the declaration described above is in conformity with the relevant union harmonization legislation:

- Electromagnetic Compatibility 2014/30/EU
- Low Voltage Directive 2014/35/EU
- RoHS 2015/863

The following harmonised standards and technical specifications have been applied:

- EN 55014-1:2017
- EN 55014-2:2015
- EN IEC 61000-3-2:2019
- EN 61000-3-3:2013+A1
- EN 60335-1:2012+A1+A13+A1+A14+A2
- EN 60335-2-29:2004+A2+A11
- EN 62233:2008

Name and Signature/Position



Mike Su – Managing Director

Date and Place

2025/5/2

Taipei, Taiwan

BC18S41-D-2509B-C1F

NOTE

SUMAKE®

SUMAKE®