

OPERATION AND MAINTENANCE MANUAL

ITEM NO.: TA-T030, TA-T030F
TA-T030S, TA-T030FS
TA-T030C, TA-T030FC
TA-T030W, TA-T030FW
TELESCOPING TORQUE ARM

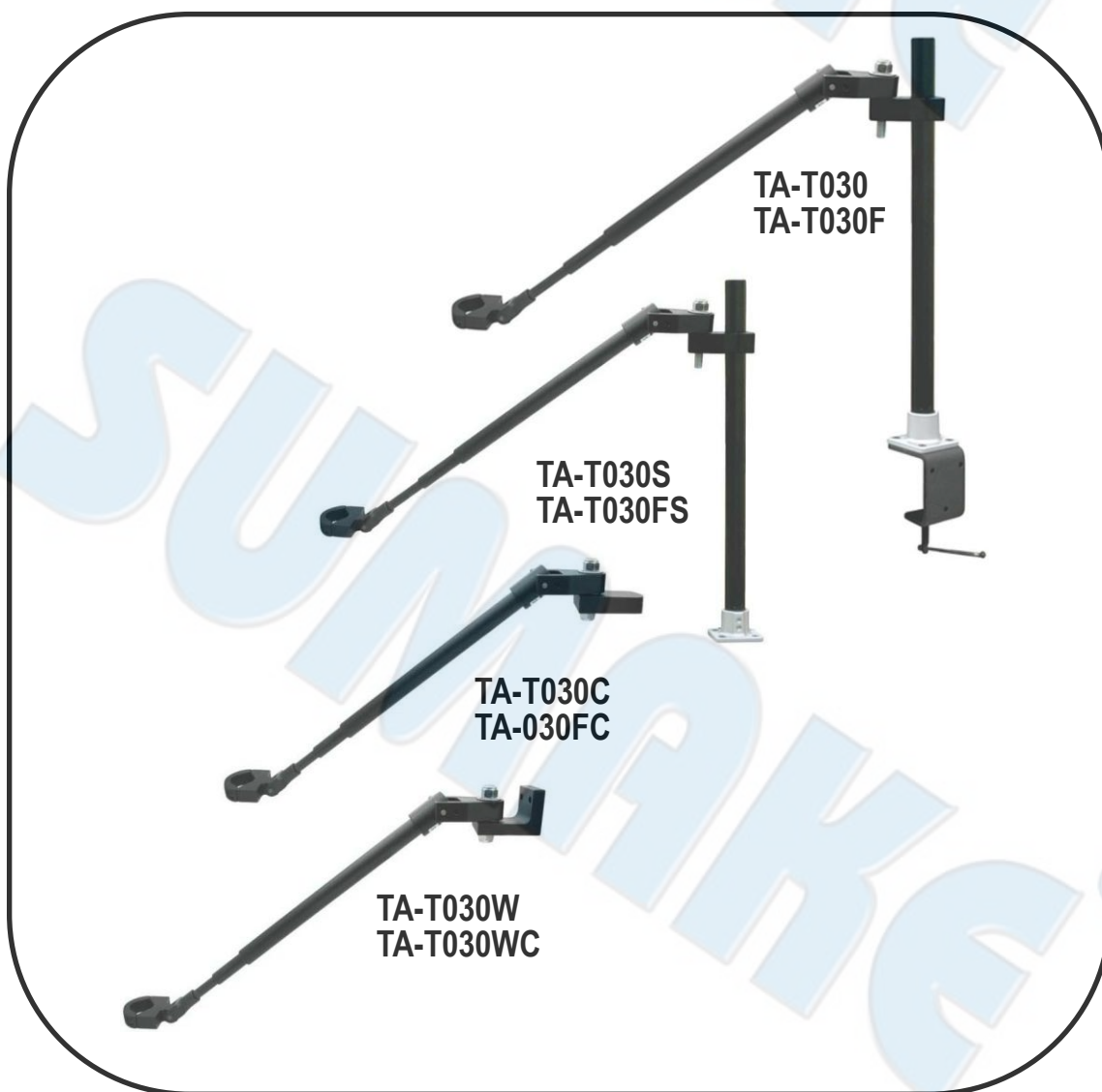

Operation Instructions

TA-T030

**Telescoping Torque Arm With Stand & Bench Clamp
(Aluminum Alloy)**

TA-T030F

Telescoping Torque Arm With Stand & Bench Clamp (Carbon Fiber)

1. Fasten the T screw counterclockwise to fix the bench clamp "A" on the table. (Make sure the clamp is securely fastened)
2. Loosen 2 inner hex screws on base "B" by 5mm hex key wrench, rotate the pillar to make the hole "C" toward to an appropriate direction which could be inserted the tool cable from it to "E" and then fastened these 2 hex screws. (Make sure the screws securely fastened)
NOTE: To prevent the tool cable be damaged during operation, it is strongly recommend insert it from "C" to "E".
3. Unfasten the sheath holder "D" with a 5mm hex key wrench, then move it to a proper vertical position and fasten it. (Make sure the screws are securely fastened)
4. In order to mount the tool on the fixture, "F" use 5mm hex key wrench to unfasten / fasten 2 inner hex screws. To prevent the tool from loosen or damaging its housing by fixture, it is strongly recommend to use a rubber sheet to cover the tool housing and tighten them together inside the fixture "F". The telescoping arm is capable of being used in the variety tool positions. (Make sure the screws are securely fastened)
5. Standard tool balancer could be used to hang the tool while using this arm. This arm is equipped with a fixture "F" as a standard part. For SUMAKE cordless tools, different tool fixture could be ordered separately.

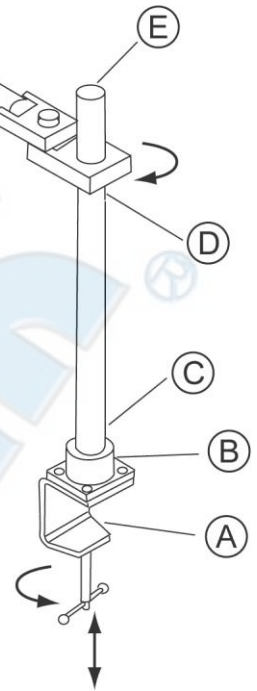

TA-T030S

Telescoping Torque Arm & Stand (Aluminum Alloy)

TA-T030FS

Telescoping Torque Arm & Stand (Carbon Fiber)

1. Open the 4 holes on the base of $\Phi 8.5$, user could chose suitable machine screw or tapping one to fix it on workbench or any other work place. (Make sure the screws are securely fastened)
2. Other operation ways are same as the above TA-T030(F) bench clamp type point 2-5.

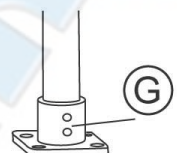

TA-T030W

Telescoping Torque Arm With Wall Fixed Attachment (Aluminum Alloy)

TA-T030FW

Telescoping Torque Arm With Wall Fixed Attachment (Carbon Fiber)

1. The wall-mounted type "A" has 2 opening hole of $\Phi 8.5\text{mm}$, user could chose suitable screw to fix it on workbench or any other work place. (Make sure the screws are securely fastened)
2. In order to mount the tool on the fixture "B", use 5mm hex key wrench to unfasten / fasten 2 inner hex screws. To prevent the tool from loosen or damaging its housing by fixture, it is strongly recommend to use a robber sheet to cover the tool housing and tighten them together inside the clamp. The telescoping arm is capable of being used in the variety tool positions. (Make sure the screws are securely fastened)
3. Standard tool balancer could be used to hang the tool while using this arm. This arm is equipped with a fixture "B" as a standard part. For SUMAKE cordless tools, different tool fixture could be ordered separately.

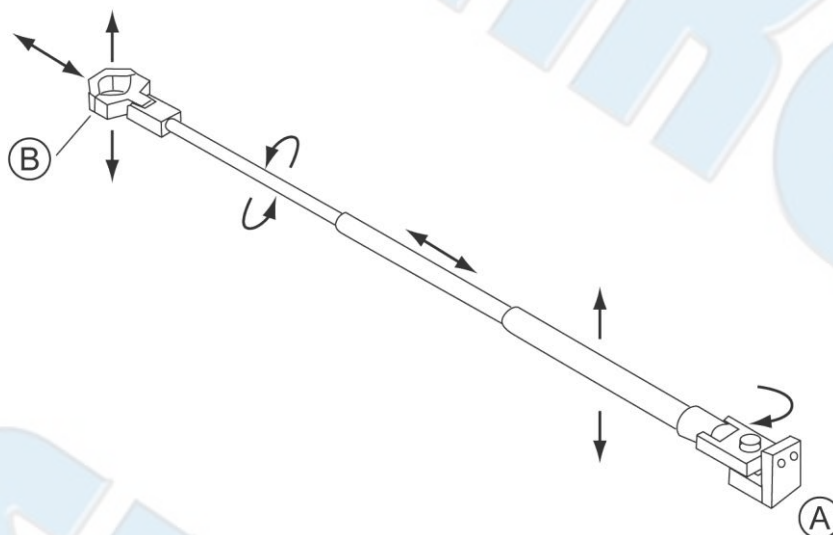

TA-T030C

Telescoping Torque Arm (Aluminum Alloy)

TA-T030FC

Telescoping Torque Arm (Carbon Fiber)

1. Fixture "C" could be mounted on a $\Phi 20\text{mm} \sim \Phi 40\text{mm}$ horizontal linear guide bush. Use 5mm hex key wrench to unfasten / fasten 2 inner hex screws on fixture "C" to fix it on a horizontal linear guide bush.
2. Other operation ways are same as the above TA-T030W(FW) wall-mounted type point 2-3.

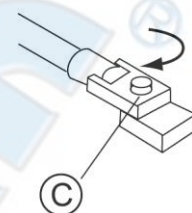

CAUTION

1. Keep work area clean.
2. The use of any part other than genuine SUMAKE replacement parts may invalidate all warranties.
3. Whenever change the screwdriver or brushes, position the Power Switch of the screwdriver to "OFF" and unplug the power cord to keep the danger off..
4. Do not use this telescoping arm for purpose not intended, like drill.
5. Inspect all joins of this telescoping arm periodically and if damaged or have operation problem, have them repaired by an authorized service facility. Keep it clean and away from greasy dirt.
6. Do not use this telescoping arm over its capacity to avoid the over load damaged and operator injury.
7. Check any missing parts on this arm visually before operation.

SPECIFICATION

Model No.	Max. Torque		Clamp Dia. (mm)		Bench Clamp Capacity (mm)	Weight (kgs)
	kgf-cm	Nm	Max	Min		
TA-T030	300	30	45	36	67	3.08
TA-T030F	500	50	45	36	67	2.93
TA-T030S	300	30	45	36	67	1.97
TA-T030FS	500	50	45	36	67	1.79
TA-T030C	300	30	45	36	67	1.32
TA-T030FC	500	50	45	36	67	1.17
TA-T030W	300	30	45	36	67	1.25
TA-T030FW	500	50	45	36	67	1.10

* Option tool clamp size $\Phi 26-40$ & $\Phi 36-50$, please add "A" at the end of Model for $\Phi 26-40$ and "B" for $\Phi 36-50$, for example TA-T030SA is with tool clamp $\Phi 26-40$.

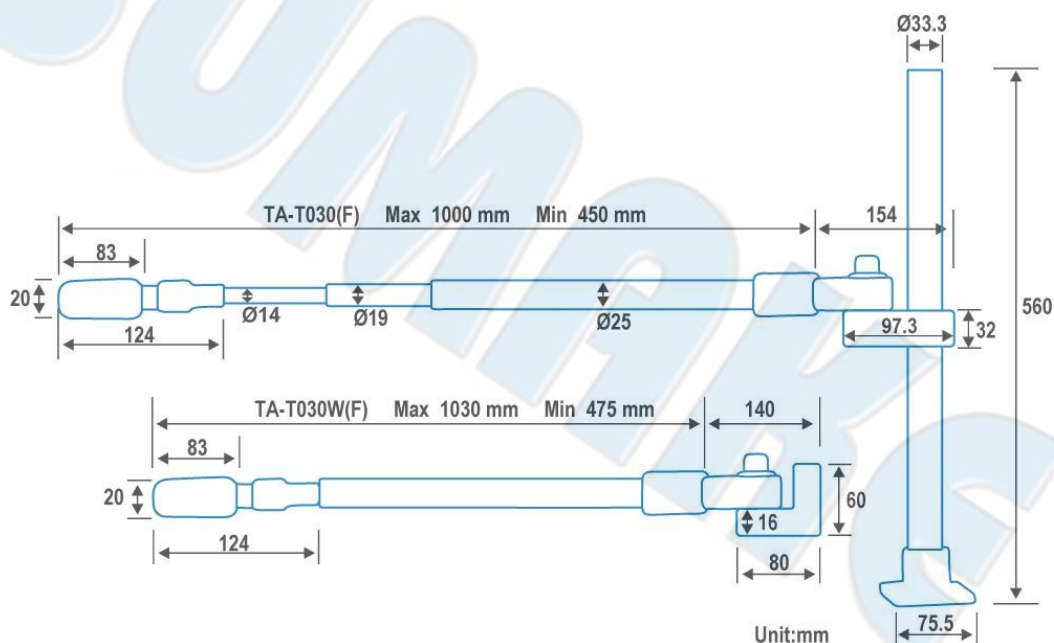



EC DECLARATION OF CONFORMITY

We: **SUMAKE INDUSTRIAL CO., LTD.**
4F, No. 351, Yangguang St., Neihu District, Taipei City, Taiwan

declare in sole responsibility that the equipment

Equipment : **TELESCOPING TORQUE ARM**

Model/ Serial No. : **TA-T030, TA-T030F, TA-T030S, TA-T030FS, TA-T030C, TA-T030FC**
TA-T030W, TA-T030FW

to which this declaration applies, complies with these normative documents:

- Machinery Directive: 2006/42/EC

and conforms to the following EN standard,

- EN ISO 12100: 2010

Name and Signature/Position

Mike Su – Managing Director

Date and Place

2013/9/14

Taipei, Taiwan

TA-T030-D-1905A-MIF

TA-T030

TELESCOPING TORQUE ARM WITH STAND & BENCH CLAMP (ALUMINUM ALLOY)

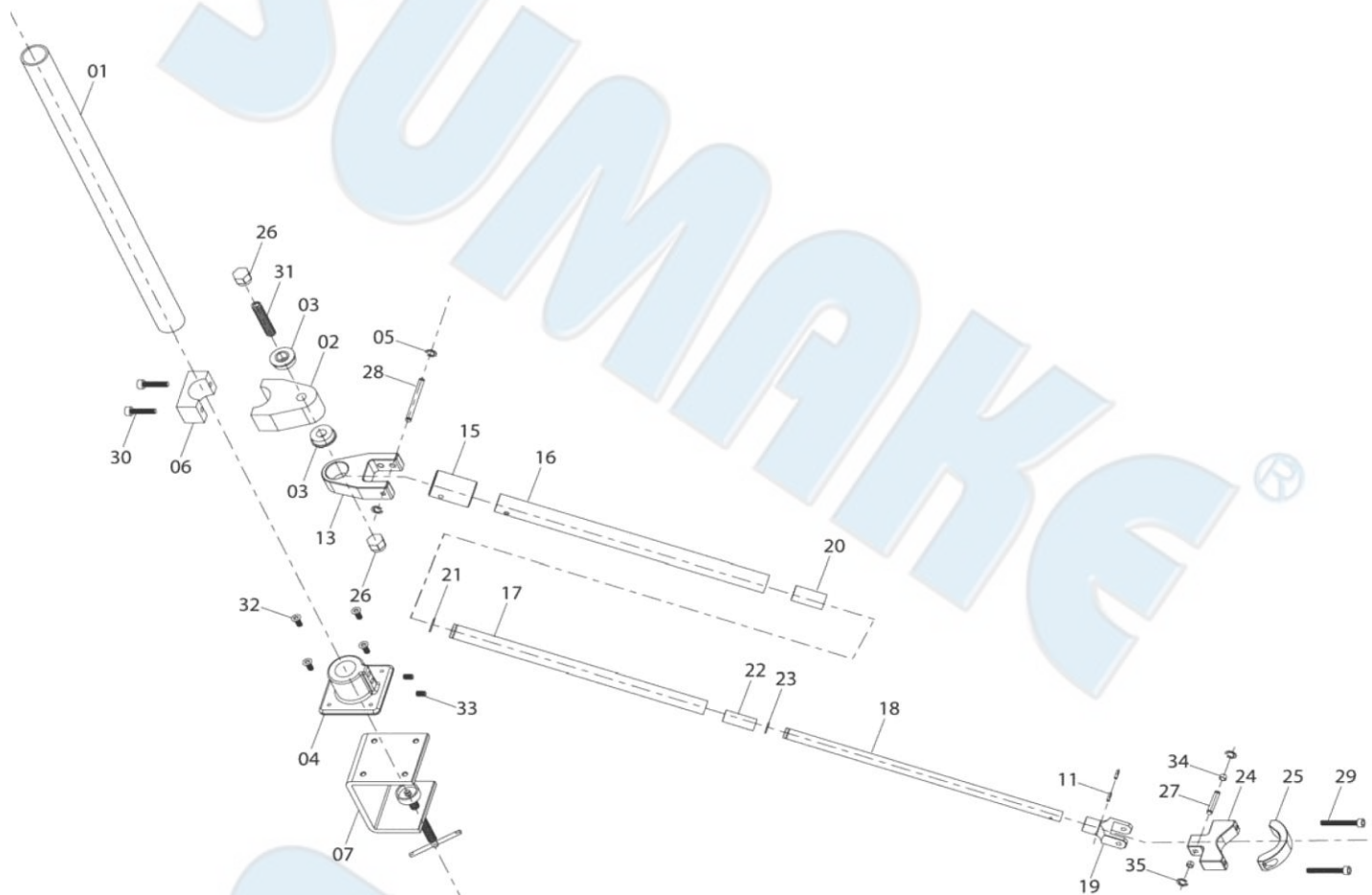

PARTS LIST

No.	Parts No.	Description	Q'ty
1	EA-01-B	Post (Black)	1
2	EA-02-B	Shoulder Clamp	1
3	EA-03	Bearing	2
4	EA-14	Table Mount	1
5	EA-39	E-Ring	2
6	EA-02-1-B	Splint (Black)	1
7	TA-1208	Bench Clamp	1
11	7S2204	Roll Pin	2
13	EJ-005	Base	1
15	EJ-007	Sleeve	1
16	EJ-008	The 1st Pipe	1
17	EJ-009	The 2nd Pipe	1
18	EJ-010	The 3rd Pipe	1
19	EJ-011	Connector	1
20	EJ-022	Bushing (Copper)	1

No.	Parts No.	Description	Q'ty
21	EJ-013	C-Ring	1
22	EJ-024	Bushing (Copper)	1
23	EJ-015	C-Ring (Small)	1
24	EJ-016	C-Clamp Holder	1
25	EJ-017	C-Clamp	1
26	EA-05	Locking Nut	2
27	EJ-019	Pin	1
28	EA-36	Clevis Pin	1
29	EJ-029	Screw	2
30	EA-44	Screw	2
31	EA-04	Double Ended Stud	1
32	EA-01-2	Screw	4
33	EA-14-1	Table Clamp Screw	2
34	EA-07-1	Copper Sleeve (Short)	2
35	EA-39	E-Ring	2

NOTE

SUMAKE®

SUMAKE®