

ST-2271(R/H)

AIR ATTACHMENT (FOR ALL AIR HAMMER)

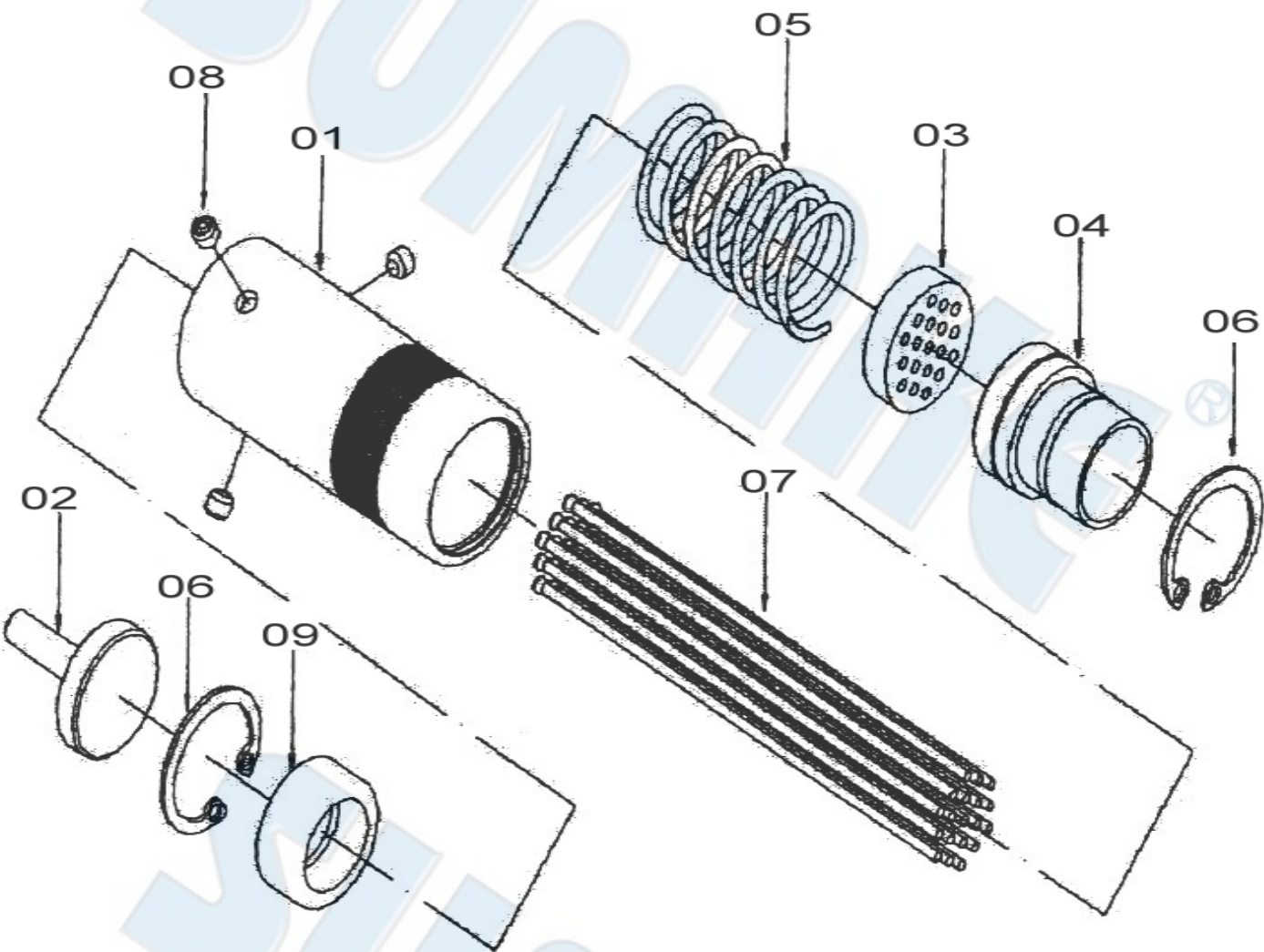

PARTS LIST

No.	Parts No.	Description	Q'ty
1	2271A-01	Housing	1
2	2271A-02	Needle Driver	1
3	2271A-03	Needle Holder	1
4	2271A-04	Needle Tube	1
5	2271A-05	Spring	1
6	2271A-06	Retainer Ring	2
7	2271A-07	Needle	19
8	2271A-08	Screw	3
9	2271A-09	Sleeve	1

1. Main Applications

- de-slagging, de-sputtering of welds
- shot-peening after welding
- cleaning metal surfaces of rust and scale
- stripping paint
- cleaning castings
- removing cores
- cleaning brick and stone-work
- cleaning ship plates, barges, buoys

2. Cautions for use

2-1 Air pressure

Maximum performance is displayed at a gauge pressure of 6 kg/cm². Range-wise, this is an air pressure from 5 to 7 kg/cm² (70 to 100 psi)



Suitable Air Pressure

2-2 Air line

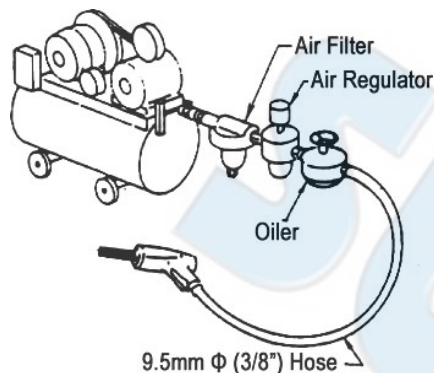

Use a 3/8" air hose between the compressor and the tool. Compressed air is cooled and its water content separated, as soon as the air leaves the compressor. A portion of the water content, however, is condensed in the piping, and can enter the tool mechanism, and may cause trouble. Always install an air filter and an oiler between the compressor and the tool. The compressor used should have 1 or higher horsepower in the case of using each one unit.

2-3 Air hose

Blow compressed air through the supply hose before connecting the tool.



2-4 Lubrication

Before connecting the hose apply 4 or 5 drops of #60 spindle oil at the air inlet. (No lubrication is required when oiler is used) Use of a thicker oil can lead to reduced performance or malfunction. If a thicker oil is used by accident, wash it away immediately. Also, every 3 or 4 hours of operation oiling is necessary.

2-5 Idle running

Idle operation will shorten the life of the tool and needles and should be avoided.

3. Cautions for operation

The quick-reciprocating needles of Jet Chisel adjust automatically to a surface contour during cleaning. Slight pressure of the needles against the work surface is sufficient for maximum performance. An upright tool position is best. The tool will efficiently clean uneven surfaces, get into grooves, corners, and gaps, clean outside and inside surfaces, and clean spaces inaccessible and too confined for other types of tools.

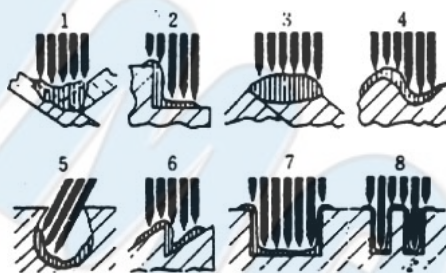

We can supply $\Phi 3$ needles for ST-2271/R, ST-2271/H

Change needles according to your work. Change the kind of needle guide according to your work.

The broken heads of needles must be removed from the cylinder, otherwise continuous operation with them causes malfunction and shortened the life of needle supporter.

4. Changing Needles

(1) Unfasten the hexagon socket head bolt of the needle guide with the hexagon wrench key and pull out the needle guide.

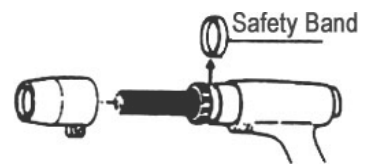

(2) Remove the safety band from the grip groove.

(3) Loosen the stop ring and remove. Take out the needle supporter by pulling out the needles.

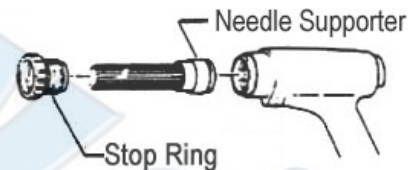

(4) Extract the needles. The needles must be changed whenever damaged during operation.

(5) After changing needles, assemble in the reverse manner of disassembly.

5. Storage

Avoid storing the tool in a location subject to high humidity. If the tool is left as it is used, residual moisture on the inside can cause rusting. Before storing, and after operation oil the tool at the air inlet with spindle oil and run it for a short time.

6. Ordering Service Parts

★ For further operational and handling information or for replacement of parts and components, contact the sale agent from whom you purchased the tool or the service division of our company.

★ In ordering parts and components, give parts number(s), name and part quantities.



ST-2271(R/H)-I-1509D-HY