

## SA-BG300-7K

### 7 IN 1 INTERCHANGEABLE AIR BLOW GUN SET



No.	Parts No.	Description
1	SA-BG300	Interchangeable air blow gun with Quick Release Knob unlocks to remove attachments in 6 different rotating positions, allowing for 6 separate angles
2	BG302	Turbo nozzle with 3 times air flow for wide rang clean
3	BG300-100	Φ6x100mm steel extension allowing for 6 separate angles
4	BG301	100mm Nylon + Glass Fiber extension allowing for 6 separate angle Ideal for mirror surface and electric car clean, non-conducting
5	BG303	1-1/4" x 42mm Fan tip, ideal for sweeps dust, dirt & water droplets from car or wide area
6	BG305	Safety venting nozzle for attach on gun body, Low noise When inlet pressure is 90 PSI prevents pressure exceeding 30 PSI if tip becomes blocked, conforming to OSHA
7	BG30C	Safety venting tip for steel extension, Low noise, Max working pressure: 190psi When inlet pressure is 90 PSI prevents pressure exceeding 30 PSI if tip becomes blocked, conforming to OSHA
8	BG30B	D16 Rubber tip, conical shaped tips for sealing area to be blown out Max working pressure: 190psi

- PP box with EVA insert: 20.7x17x5.5cm
- Full range trigger control, easily feather from 1-100%
- Ideal for cleaning debris from a work space, drying wet surfaces, blowing up balloons and many more creative applications
- Hook and hanging hole for easy place

### Specification:

- Body: Nylon + Glass Fiber
- Trigger: POM
- Piston: Nylon + Glass Fiber
- Air Inlet: Brass
- Working Pressure: 110~160 psi (7.7~11kg/cm<sup>2</sup>) for gun body
- Max. Working Pressure: 220 psi (15kg/cm<sup>2</sup>) for gun body
- Air Inlet Thread: 1/4"
- Air Consumption(85psi): 7.6cfm (215 l/min)
- Temperature range: -20°C to 85°C (-4°F to 185°F)

Align one of the scales with arrow

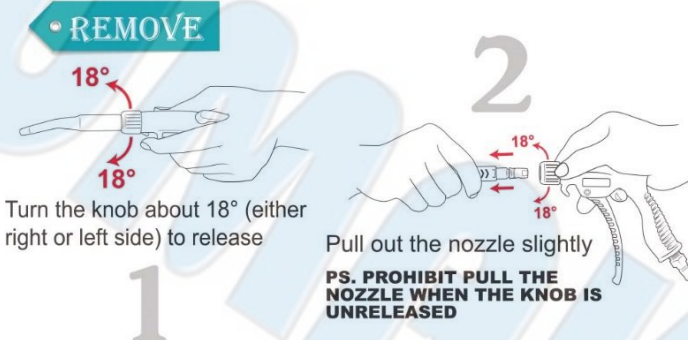
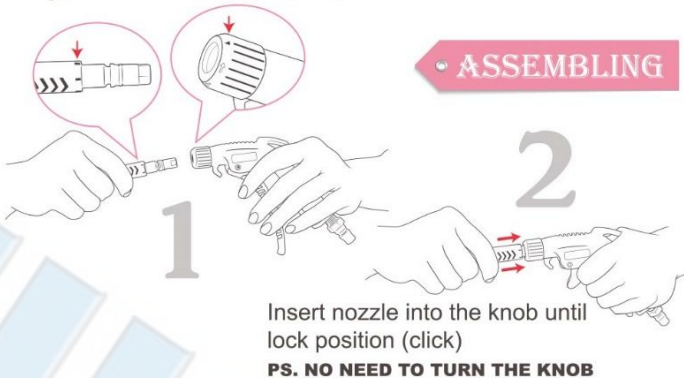

SA-BG300-7K-I-2007A-J6