

SC-9803

SUCTION CUP-3 GRIPS FIX STYLE (NICKEL PLATED)

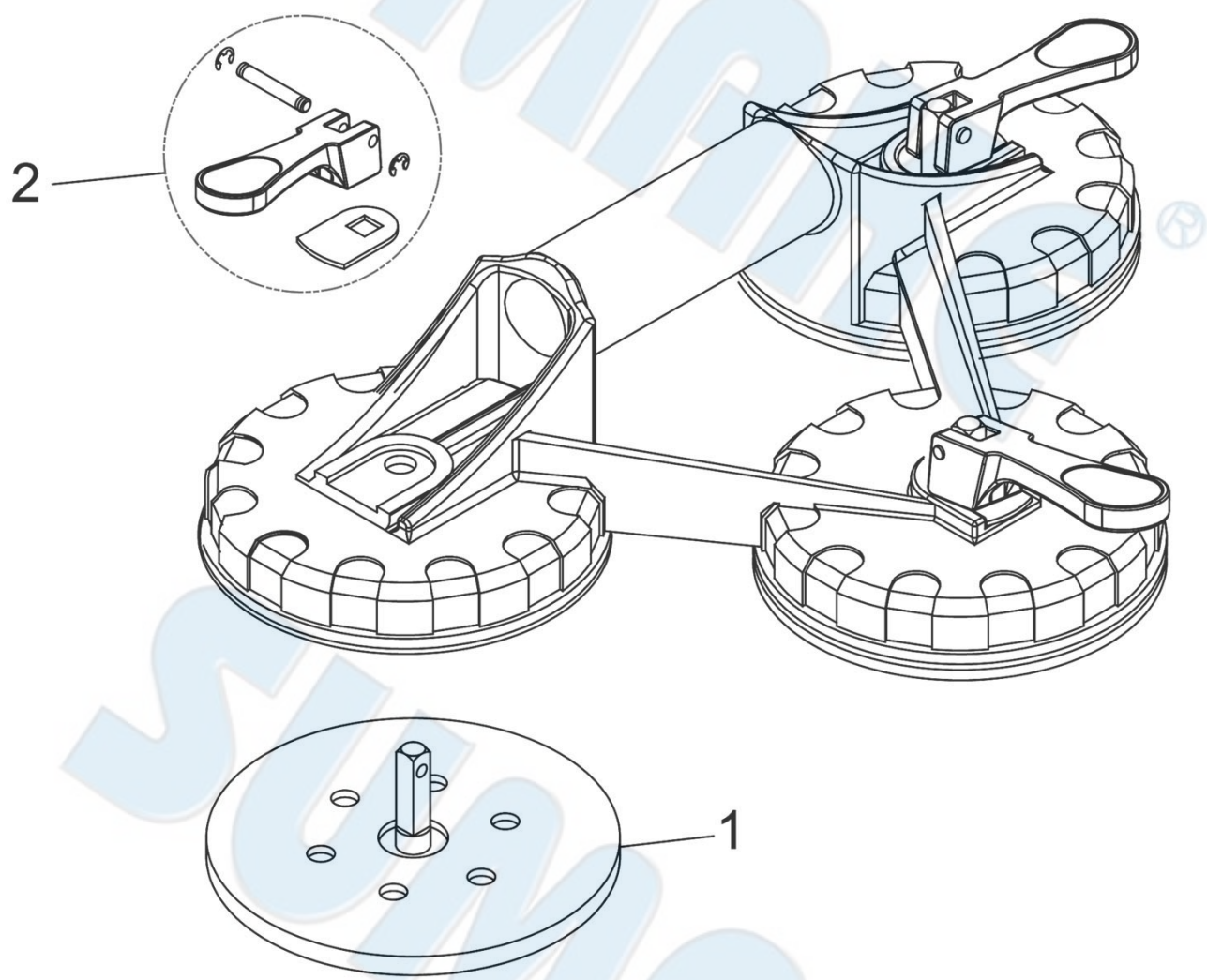

PARTS LIST

No.	Parts No.	Description	Q'ty
1	SC9803-01	Rubber Pad	1
2	SC9803-02	Lever Assembly	1

MULTI-FUNCTION SUCTION LIFTER

Before you use it please read it carefully.

Operation For Hand Pump Suction Lifters Only

To Attach

- ★ Position the hand cup on the mounting surface so the red line will be visible if it should appear while lifting the load. CAUTION : Test the cup for staining or deformation on surfaces with light colors or soft coatings.
- ★ Pump the plunger until the cup attaches completely. When the red line is hidden, vacuum is sufficient for lifting.
- ★ Check the plunger frequently to make sure the cup remains securely attached. If the red line appears while lifting, set down the load immediately and pump the plunger until the red line is hidden again.

To Release

- ★ Set the load on a secure support.
- ★ Pull one of the release tabs or press the valve release lever (on other cups) until the cup disengages completely.

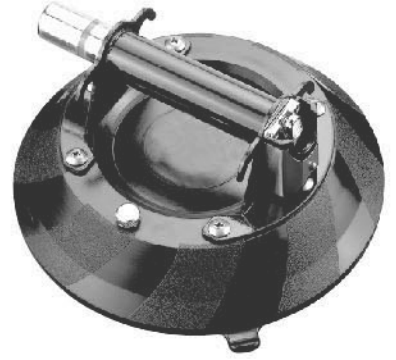

Safety Instruction

- ★ Suction lifters are hand tools and must not be used in connection with cranes or other lifting devices.
- ★ Before each use, make sure the suction pad is smooth, clean, undamaged and without any cracks.
- ★ Clean suction pads regularly with spirit or other non-aggressive cleaners.
- ★ Make sure the surface / object to be lifted is of non-porous material. In addition, the surface must be clean, dry and free of oils and grease. On rough or porous surfaces, the holding capacity decreases or is non-existent.
- ★ Do not use any sharp objects to loosen the suction lifters from the surface as this will damage the suction pad.

Purpose

- ★ Used to carry glass marble or any other smooth materials.
- ★ Vacuum-attaching hand tools for lifting and carrying loads. Spring-balanced pump maintains consistent vacuum level, use on clean, relatively smooth, nonporous surfaces; Moisture or contaminants can reduce the slip resistance of the cup.

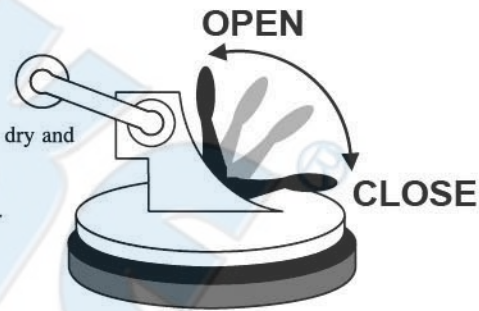

Attention Important safety instructions:

In order to achieve the best possible degree of safety, please observe the following rules:

- ★ Only use the suction lifter if you are experienced or under supervision by someone experienced in handling this tool.
- ★ Always test the functioning of the suction lifter prior to its use. Examine handle for dents or cracks. Examine rubber pads for excessive glaze, cuts or roughness.
- ★ Suction lifter should only be used for lifting, carrying and holding objects for a short period of time. However, in the case of long periods of attachment, check suction lifter regularly to ensure firm adhesion. If grip dose not feel sufficiently firm, reapply suction lifter.
- ★ Suction lifter is a hand tool and should not be used as a crane, hoist or similar. Store suction lifter in a flat, relaxed position when not in use.
- ★ Prior to use, always check the rubber pads for possible loss of suction capacity due to reduced elasticity caused by excessive age, usage, maintenance, storage etc. Rubber pads, which are damaged or lack sufficient suction capacity must be replaced. Never use suction lifter with damaged rubber pads or insufficient suction capacity!
- ★ Do not exceed stated lifting capacity of suction lifter. (Float glass) at a room temperatures of 20°C. Cold temperatures, humidity and pollution, carelessly treated or even damaged suction pads or usage on other materials than flat glass (such as structured glass, plastics, stone, metal, etc.) may reduce the holding capacity considerably.
- ★ Do not use the cup to support a person.
- ★ Do not place the cup face against surfaces which could damage the sealing edges.
- ★ Avoid conditions that could cause the cup to slip or to disengage prematurely, such as: contaminants, cuts or scratches in the cup face or mounting surface.
- ★ Do not allow anything to interfere with free movement of the plunger while the cup is attached.
- ★ Do not touch the release tabs (on 6"/153mm cups) or the valve release lever (on other cups) while lifting.
- ★ Do not use solvents, gasoline or other harsh chemicals to clean the cup.

Maintenance

- ★ Always keep rubber pads clean and free of oil or grease. Clean suction pads regularly with spirit or other non-aggressive cleaners.
- ★ Do not expose rubber pads to sunlight over extended period of time to preserve their elasticity.
- ★ If the hand cup dose not function normally (see Inspection), the cup face may be dirty or the cup may require service.
- ★ First clean the cup face according to the directions to follow. If the condition persists, contact our Customer Service department or an authorized dealer for assistance.

- ★ The permissible load is given for a clean, dry, and smooth surface at 20°C(68°F).

使用前請詳閱下列注意事項

- ★ 此吸盤只可用於平面且乾燥的物體。
- ★ 不可以以任何機械搬運吸盤所附著的物體。
- ★ 如發現吸盤表面有裂痕或者刮痕時，請停止使用，並速更換。

注意：

- ★ 不可使用於表面有任何液體的物體搬運，如水、油…等。
- ★ 在搬運過程中禁止碰觸把手開關。
- ★ 吸盤附著於表面時間不可過久。
- ★ 所搬運的物體不可超過所規定的重量。
- ★ 請定期檢查吸盤是否有無損壞或鬆動。
- ★ 請勿放至於太陽底下或高溫場所，請置於陰涼處。

MULTI-FUNCTION POWERFUL SUCTION LIFTER

バキュームキャップの使用方法

- ★ スチール、ガラス、大理石などで表面が平らで硬い物に必ず完全に吸着させてご使用下さい。
- ★ 吸着キャップを固定しようとする場所が、汚れ又は油が付着していないかを確認して下さい。もし、汚れや油分がある時は、それらをきれいに除去し充分に乾燥させてください。
- ★ 吸盤を吸着したら、移動する前に完全に吸着されているか少し持ち上げて確認してください。
- ★ 吸着を解除する時は、危険のない場所に吸着物を置いて周囲の安全を確認して吸着を解除してください。

ご注意

- ★ 使用される前に、本品に破損、ヒビ割れ等がないかご確認ください。また吸着時は必ず表面が堅くて完全に平面な物に使用してください。
- ★ バキュームキャップの最大荷重がありますから、それ以上の重い物体を持ち上げないでください。
- ★ 使用される時は、常に充分吸着力を確認してからご使用ください。
- ★ 物体を運送中に吸着キャップが外れたり、または被物体に異常を感じた時はすぐに使用を中止してください。
- ★ 木製品には、使用しないでください。また、塗装状況によっては、塗装がはがれる事がありますので、ご注意の上ご使用ください。
- ★ 吸着ラバーキャップは、汚れ、油分を常に除去し、きれいに保管して使用ください。

Hand-pump vacuum suction lifters



Heavy-duty sheet metal handling tool



Heavy-duty double cup sheet metal handling tool



4 pcs composite scraper kit



5 pcs trim fastener and molding removal kit



Heavy-duty sheet metal handling tool



Glass carrying device



Heavy-duty Triple cup sheet metal handling tool



⚠ **WARNING:** Cancer and reproductive harm - www.P65Warnings.ca.gov.
 ⚠ **AVERTISSEMENT:** Cancer et troubles de l'appareil reproducteur - www.P65Warnings.ca.gov.
 ⚠ **ADVERTENCIA:** Cáncer y daño reproductivo - www.P65Warnings.ca.gov.

