

Operation Manual GENERAL PURPOSE

WARNING: BEFORE USING THE WINCH, READ ACREFULLY THIS MANUAL AND KEEP IT FOR FUTURE NEEDS.

(A) USE

Lifting of the load must happen by rotating the crank clock-wise. When releasing the crank, the load remains suspended. The descent of the load must happen by rotation the crank countclock-wise.

(B) WARNINGS FOR THE SAFETY OF YOURSELF AND OF OTHER PEOPLE

- The use of the winch is not allowed for lifting people or for lifting things over areas where people may loiter or pass by.
- Do not lift any load when the rope is completely unrolled.
- Make sure that there are three complete rope coils rolled on the drum.
- Use the winch only by hand and with the crank 195 mm long included in the equipment. In case it is difficult to rotate the crank with only one hand, must probably the maximum capacity had been exceeded.
- The winch must not be kept under continous loading.

(C) GREASING

It is advisable to lubricate frequently the holes guiding the shafts and the drum hub, and to grease the teeth of the two gear and of the thread of the crank shaft.

If installed in the open, it must be protected from dust, from dirt, rain, and should be more often checked and lubricated.

(D) FIXING OF ROPE TO DRUM

A. One Rope

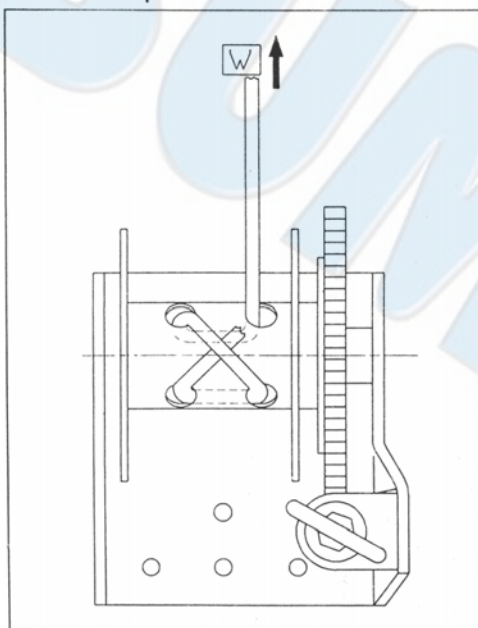

B. Two Rope

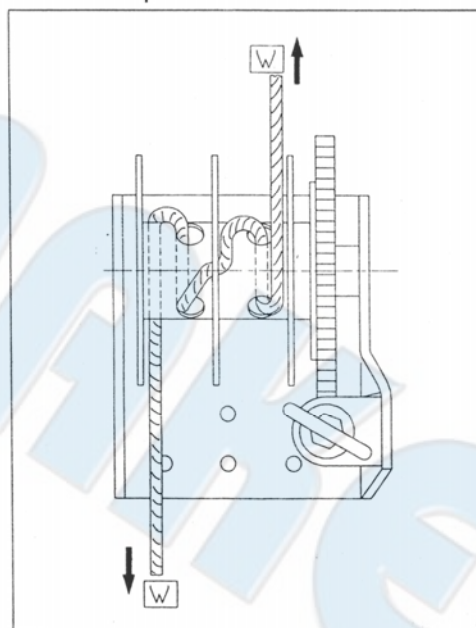

(E) TECHNICAL INFORMATION:

Capacity	(lbs / kg)	1500 / 680
Lift Per Crank Rotation	(mm)	7.5
Hand Force Required	(lbs / kg)	10 / 4.5
Gear Ratio		41 : 1
Hub Diameter	(mm)	Φ48
Handle Length	(mm)	195
Rope Storage Capacity	(mm)	47M / Φ3MM
		23M / Φ4MM
Unit Weight	(kg)	4.9

(F) PARTS LIST

HW-680 GENERAL PURPOSE

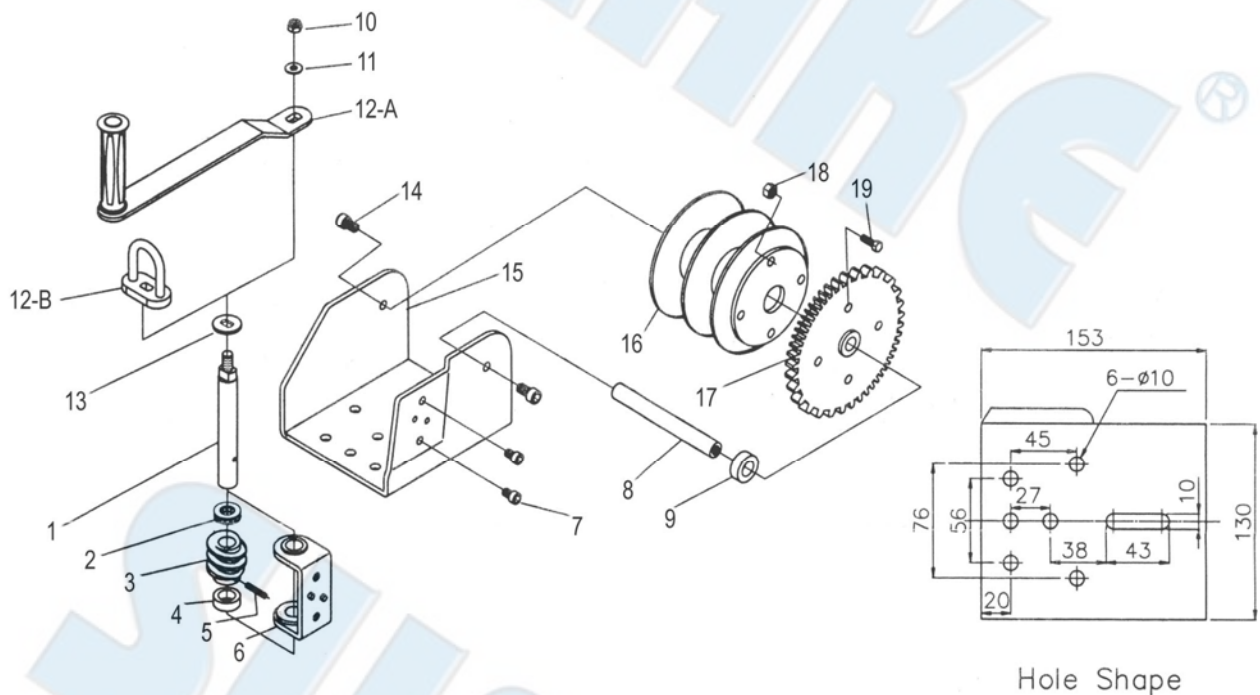

PARTS LIST

No.	Parts No.	Description
1	HW680-01	Worm Gear Shaft
2	HW680-02	Ball Bearing (51102)
3	HW680-03	Worm Gear
4	HW680-04	Worm Gear Collar
5	HW680-05	Spring Pin (Φ5x24mm)
6	HW680-06	Worm Gear Base
7	HW680-07	Screw (M8x12mm)
8	HW680-08	Reel Shaft
9	HW680-09	Reel Collar
10	HW680-10	Nylon Nut (M8)

No.	Parts No.	Description
11	HW680-11	Washer
12A	HW680-12A	Handle
12B	HW680-12B	Loop
13	HW680-13	Washer
14	HW680-14	Screw (3/8"x3/4")
15	HW680-15	Winch Frame
16	HW680-16	Winch Reel
17	HW680-17	Reel Gear
18	HW680-18	Nu (5/16")
19	HW680-19	Screw (5/16"x34")