EC DECLARATION OF CONFORMITY

FOR MACHINERY

Manufacturer : **SUMAKE INDUSTRIAL CO., LTD.**

CE Declaration of conformity ENGLISH
SUMAKE Co. declares that the product as described in attached documentation is in conformity with the Machinery Directive 2014/68/EU .

CE Dichiarazione di conformità ITALIANO
SUMAKE Co. dichiara, assumendo la piena responsabilità, che questa fissatrice è conforme alla Direttive Europee 2014/68/EU .

CE Konformitätserklärung DEUTSCH
SUMAKE Co. erklärt hiermit in alleiniger Verantwortung das dieses Gerät übereinstimmt mit den Europäischen Richtlinien 2014/68/EU .

CE Declaration de conformité FRANCAIS
SUMAKE Co. declare et prend sur soi toute la responsabilite de cette declaration, que le produit est en conformité avec les Directives Europeennes 2014/68/EU .

CE konformiteitsverklaring NEDERLANDS
SUMAKE Co. verklaart hierbij onder eigen verant woordelijkheid dat deze machine in overeenstemming is met de Europese Richtlijnen 2014/68/EU .

CE Declaracion de conformidad ESPANOL
SUMAKE Co. declara que el producto descrito en documentacion adjunta es conforme con la directiras Maquinaria 2014/68/EU .

Machine Type : AT-10M
machine name : 10L Air Paint Tank-Manual Type

Place,Date of issue
4F, NO.351, YANGGUANG ST., NEIHU DISTRICT, TAIPEI CITY 114, TAIWAN
December.1th,2022

Signature of issuer:



AT-10M-D-2307D-YHF

2-1/2 Gallon PRESSURE TANK

Operating & Maintenance
Instructions

■ **MANUAL**

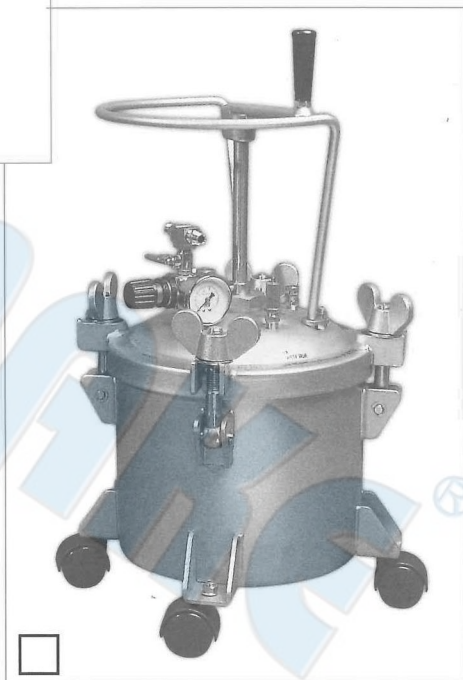

SAFETY INSTRUCTIONS

DANGER 



Do not attempt to operate the tool until you read and understand all safety precautions and manual instructions.

Never allow using oxygen or combustible gas as a power source for the tool. Use filtered, lubricated, and regulated compressed air only.

Never use gasoline or other flammable liquids to clean the tool. Vapors in the tool will ignite by a spark and cause the tool to explode.

While using this pressure air tank do not exceed maximum permissible operating pressure 5 bar.

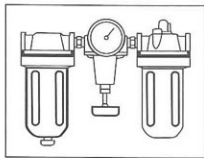

- Many air tool users find it convenient to use oiler to help provide oil circulation through tool and increase the efficiency and useful life of the tool. Check oil level in the oiler daily. Many air tool users find it convenient to use a filter to remove liquid and impurities, which can rust or wear internal parts of the tool. A filter also increase the efficiency and useful of the tool. The filter must be checked on a daily basis and if necessary drained.

WARNING 

- Wear hearing protection Employers and users are responsible for Ensuring the user or anyone near the tool wears this safety protection.
- Never point any operational pneumatic tools at yourself or at any other person.
- End users are responsible for the CE compliance safety valve.
- Anti electro static discharge shall be taken cant at some AEA.



Installation of Pressure Tank

Before use, the nozzle shall be checked for well connection for inlet (compressed air) and outlet (paint hose).

Fill of contain shall not be over its 80% of shell height and follow the instruction as below,

- Do not open the lid at any time before the pressure gauge returns to zero. To ensure safety, persons who operate this device shall be well trained.
- When processing the loading and unloading lids make sure that the temperature is below 40°C and the tank pressure is at 0kg/smf G before opening the lids.
- When processing the contain loading and unloading, first loosen the wing nuts and open the lid slightly to make sure that there is not residual pressure left in the tank. After checking, remove wing nuts and fully open the lid. Loosen the wing nuts in the order as shown in following diagram.

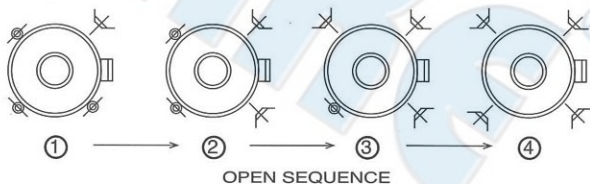

SCHEMATIC DRAWING

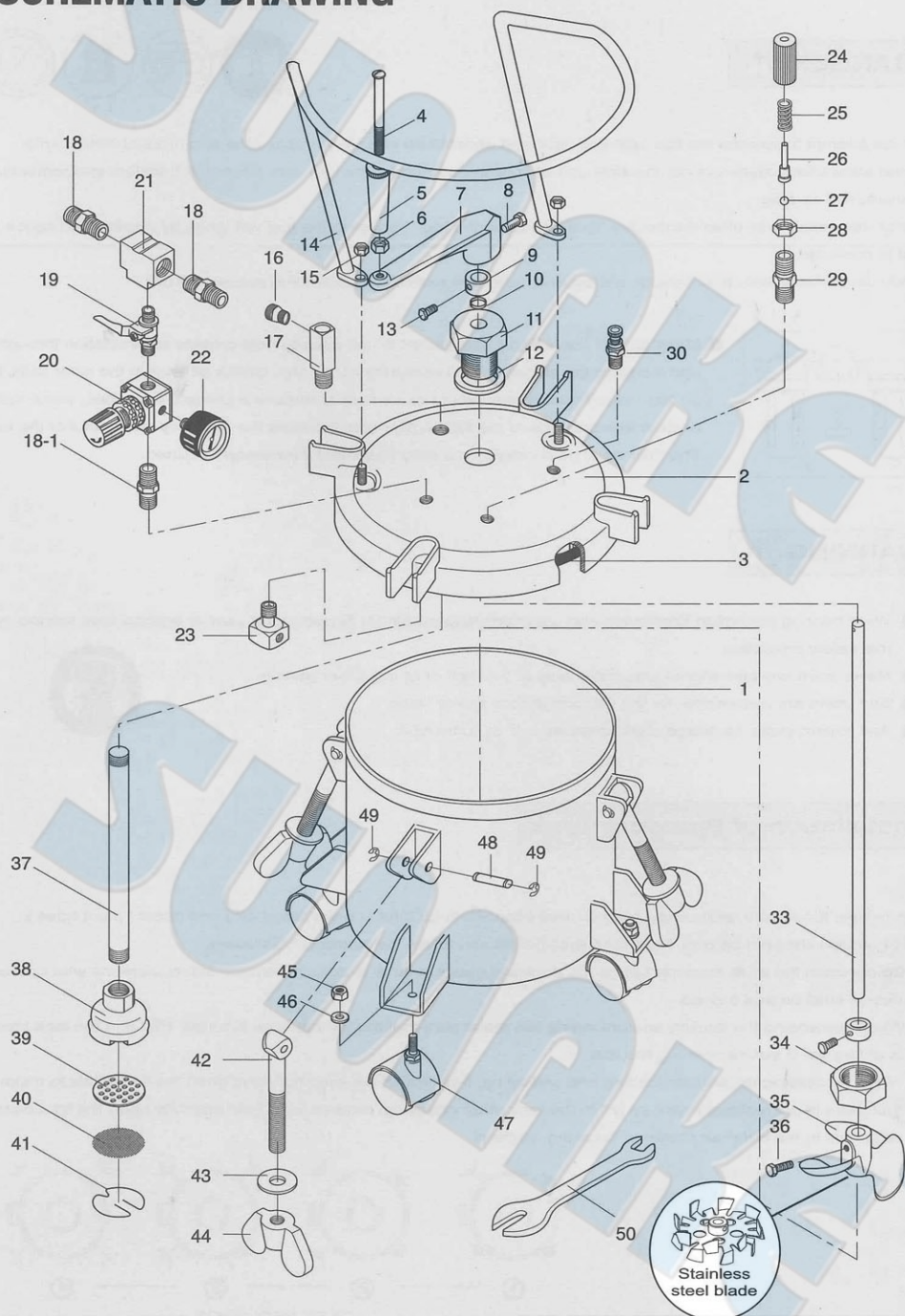

PARTS NO.	DESCRIPTION	Q'TY
※ 1	Material tank	1
※ 2	Lid assembly	1
3	Gasket	1
4	Screw bolt	1
5	Handle bar	1
6	Hexagon nut	1
※ 7	Swing rocker	1
※ 8	Screw bolt	1
9	Connecting ring	2
10	O-ring	2
※ 11	Contering guide	1
12	Seal ring	1
13	Screw bolt	2
※ 14	Parts guard	1
※ 15	Hexagon nut	2
※ 16	Adapter	1
※ 17	Material outlet adapter	1
18	Adapter(airinlet)	2
※ 18-1	Adapter	1
19	Air in cock	1
20	Pressure regulator	1
21	Branch tee	1
22	Pressure gauge	1
23	Air flow guider	1
24	Safety valve shell	1
※ 25	Spring	1
26	Needle rod	1
27	Steel bal	1
28	Hexagon nut	1
29	Adapter	1
30	Release Valve	1
※ 33	Agitating rod	1
※ 34	Hexagon nut	1

PARTS NO.	DESCRIPTION	Q'TY
※ 35	Agitating blade	1
※ 36	Screw bolt	1
※ 37	Fluid tube	1
38	Absorption apparatus	1
39	Filter base	1
※ 40	Material filter	1
※ 41	Snap ring	1
※ 42	Swing bolt	4
※ 43	Washer	4
※ 44	Thumb nut	4
45	Nut	4
46	Washer	4
47	Wheel	4
※ 48	Cotter pin	4
※ 49	C-snap ring	8
50	Spanner	1

NOTE : ※ Stainless Stell made parts available for stainless pressure tanks.

GENERAL INTRODUCTION

This pressure air tank is durability, all the component parts are made with the finest materials and were strictly inspected before assembly. The surface of the whole tank were also treated with special paint to carry out a durable and cheerful appearance. The material being sprayed can be agitated manually by the agitating rod occasionally. That keeps the material smooth all the time during spraying and prevents the target product from color difference caused by material settling. This type of air tank is good enough for the material being sprayed is not too sticky and not too easy to settle down. The capacity of this versatile tank enables the operator to carry out almost any job with professional results. What's more, special materials such as enamel paint, chemical liquid, glue, fluid food, sticky material...etc can also be transpoted as smoothly as required.

CAUTION

For the sake of performing perfectly all the time. Thoroughly cleaning is advised to execute right after every spraying. That ensures not only to reduce the necessity for spare parts and also to prolong the life-span of the tank.

WARNING

- 1** This pressure tank is only allowed to provide material pressurized up to maximum load of 80 PSI. **Exceed this allowable load will result in explosion!**
- 2** The safety valve is designed to protect the tank from over pressurized. The original valve of it is set as **60 PSI**.
Make sure not to adjust it if not necessary indeed.
- 3** Do not make drilling, welding or other form of machining to any part of the tank. Because the tempering caused by those in - proper preforming will weaken the structure.

OPERATING

Check and make sure there is no pressurized air remained in the tank before using. If there is, release it by turning release cock clock - wise - until pressure bleeds down to Zero.

After install the cover to shell, it is necessary to check if any leakage from the interface. It is necessary to check the tightness of nut during the usage.

- 1** Loosen all thumb nuts and swing bolts, then remove the lid assembly away from the main tank.
- 2** Pour the material being sprayed into the materials tank.
- 3** Replace the lid assembly and tighten it with main tank securely.

TIGHTEN SEQUENCE: 1. → 2. → 3. → 4.

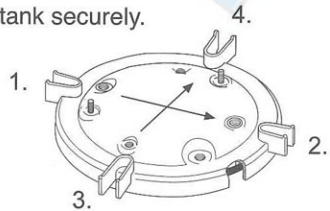

- 4** Connect the air supply hose to the air inlet.

Suggestion: It's better to add an air filter between this hose and the air inlet. For it can purify the air from dirt and entrained water or oil, which are not good to the material being sprayed.

- 5** Connect the atomizing air hose to the air outlet cock.
- 6** Turn on the air valve cock-wise to gain a proper speed for the air motor to agitate the material.
- 7** Connect the material hose to the material outlet cock.
- 8** Turn on the air supply, then turn air pressure regulator clock - wise to gain proper working pressure.

Make sure not to adjust it over 80 PSI! (See maximum pressure on nameplate)

- 9 Turn on air outlet cock.
- 10 Turn on fluid outlet cock.
- 11 Atomizing air for the spray gun can be adjust at the gun by means of turning an adjust valve on it.
Or, adding an air regulator kit to the tank can be the same.
- 12 Operate your spray gun according to the instructions attached with it.
- 13 Refer to the figure shown for a typical assembly.



- 1.Regularly checking of safety valve is necessary.Do not attempt to repair or adjust the safety valve.
- 2.Operating the agitator without liquid inside will damage the equipment.

CLEANING AND MAINTFNANCE

Thorough cleaning performed right after operating is always necessary.

That reduce the necessity for spare parts and also prolong the durability of the tank.

Cleaning procedure:

- 1 Turn air inlet cock off.
- 2 Turn on material cock.
- 3 Release all pressure air remains in the tank.
- 4 Loosen all thumb nuts and swing bolts, then move the lid assembly to one side of the tank.
- 5 Loosen air cap retaining ring on spray gun about 3 turns.
- 6 Cup cloth over air cap on the gun, then pull trigger. This will force material back into the tank.
- 7 Empty the material tank. Then take some proper solvent to clean all the tank and the other parts which contact with material.
- 8 Pour clean solvent into the tank.
- 9 Replace the lid assembly back and tighten all the thumb nuts.
- 10 Turn air inlet cock on.
- 11 Operate the spray gun until clean solvent appears.
- 12 Repeat steps 1 - 6 in order to force solvent back to the tank.

TROUBLE SHOOTING

PROBLEM	CAUSE	REMEDY
Indicator on air pressure gauge is out of function	Broken or damaged	Replace it
Material settles during operation	Material agitating insufficient or the agitating propeller may loosen or the air motor may be malfunctioned.	Increase agitating or tighten propeller or check and replace parts involved
Material or air leak from lid gasket	Lid gasket is worn or thumb nuts not tightened	Replace it or tighten it
Air leak from release cock after being screwed	The O-ring in it is damaged	Replace it
Material does not come out smoothly	Filter or Fluid tube is clogged	Check and clean it
Note: Check pressure gauge occasionally. The indicator should indicate to zero when there is no pressure in the tank		

※ **Stainless steel pressure tank is recommended for the application of waterbased material or acid material, alkaline material, Corrosive material or high viscosity material.**